

# Max-Flo

## Diaphragm Valve Assembly Instructions

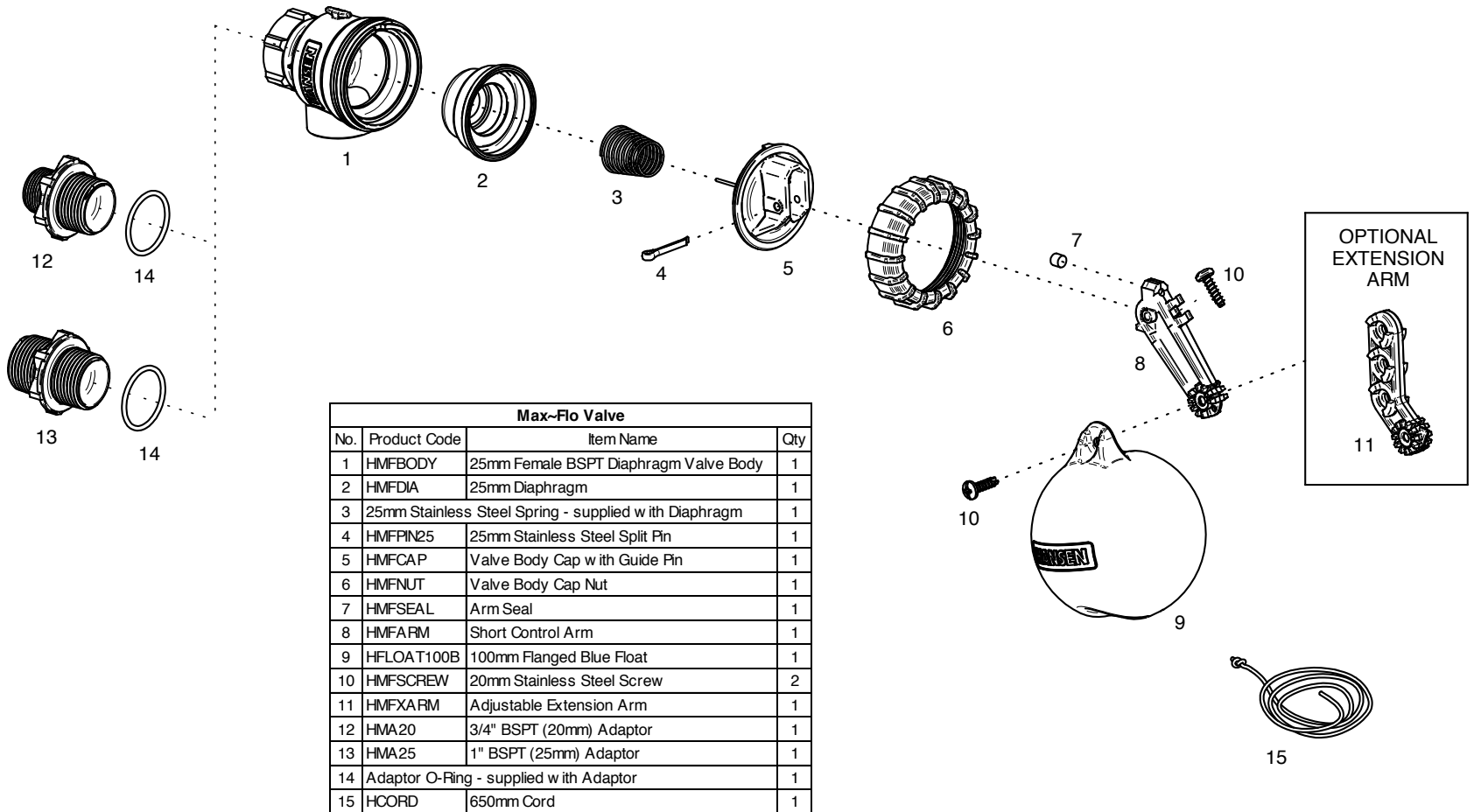

Max-Flo Valve			
No.	Product Code	Item Name	Qty
1	HMFBODY	25mm Female BSPT Diaphragm Valve Body	1
2	HMFDIA	25mm Diaphragm	1
3		25mm Stainless Steel Spring - supplied with Diaphragm	1
4	HMFPIN25	25mm Stainless Steel Split Pin	1
5	HMFCAP	Valve Body Cap with Guide Pin	1
6	HMFNUT	Valve Body Cap Nut	1
7	HMFSEAL	Arm Seal	1
8	HMFARM	Short Control Arm	1
9	HFLOAT100B	100mm Flanged Blue Float	1
10	HMFSCREW	20mm Stainless Steel Screw	2
11	HMFARM	Adjustable Extension Arm	1
12	HMA20	3/4" BSPT (20mm) Adaptor	1
13	HMA25	1" BSPT (25mm) Adaptor	1
14		Adaptor O-Ring - supplied with Adaptor	1
15	HCORD	650mm Cord	1