



## What is an Irripod Effluent System

- Irripod Effluent Systems are flexible, cost effective Pod Pipeline Systems for Effluent Distribution.
- Designed to operate at low pressure. The Irripod Effluent System distributes liquid effluent on a slow absorption rate over a 12-24 hour period. This allows for effective absorption into the soil whilst eliminating pooling and run off.
- The Irripod Effluent System is a component system that is simple to install and manage.
- The Irripod Effluent System utilises Protective Pod Skid covers over sprinklers that are attached to a 45mm Effluent Pipeline.
- The Irripod Effluent System can be configured to suit individual requirements depending on the application rates, the distance to be irrigated and the rotation intervals appropriate for the situation.
- Each Irripod Effluent System can be customised to suit varying paddock sizes and shapes while also accommodating existing obstructions.
- Irripod Effluent Systems are strong, lightweight and flexible.
- Easily moved by attaching the Hydrant or Pod lines to an ATV or farm vehicle.
- The irripod effluent system is designed to distribute liquid effluent (Solid materials separated via a dual pond system or solid separator, *not included*).

NOTE: The Irripod Effluent System has been designed to distribute liquid effluent only, it is important to remove solid materials.

## What is an Irripod Irrigation System

- Irripod Plus is a flexible, cost effective pipeline sprinkler irrigation system for pasture and forage crops.
- Designed to operate at low pressure Irripod Plus distributes water on a slow absorption rate over a 12-24-hour period. This allows for effective absorption into the soil whilst eliminating pooling and run off. The system only requires movement once per 12-24 hour period.
- Irripod Plus is a component system that is simple to install and manage. The system utilises protective Pod Skid covers over sprinklers that are attached to an irrigation pipeline. Irripod Plus can be configured to suit individual requirements dependent on application rates, the distance to be irrigated and the rotation intervals appropriate for the situation. Each Irripod irrigation line can be customised to suit varying paddock sizes and shapes while also accommodating existing obstructions.
- Irripod irrigation lines are strong, lightweight, flexible and easily moved while the system is operating by attaching the lines to an ATV or farm vehicle.
- The flexibility of Irripod Plus means the system can be configured for many different end uses in addition to traditional pasture and forage crop irrigation; these include orchards, golf courses, sports fields, race tracks, dust suppression in developing housing sub-divisions and bush fire protection.

With over 60 years experience in manufacturing, Hansen Products knows the importance that pipe fittings play in the performance and control of fluid delivery, flow and pressure within a pipe system. This has seen Hansen Products build a reputation for providing high performance, easy to use, innovative, simple products that provide our customers with "Best Installed Value". All Hansen products carry our Limited Lifetime Warranty.\*

\*For more information on our warranty please go to Legal section.



*Irripod White Pod Irrigation System (IRRW) in use*



*Irripod End of Line Single Pod (SINGLE25M) in use*

## Complete Irripod



**Complete White Irripod  
 Includes Tapping  
 Saddle Kits & Sprinkler  
 Riser  
 (Sprinkler Sold  
 Separately)**

### Code & Description

**Pack  
 Size**  
 EA

#### **IRRW32LACME**

White Pod Cover, Black Base, 32mm LDPE Tapping Saddle Kit,  
 Low Riser ACME

#### **IRRW32L15FM**

White Pod Cover, Black Base, 32mm LDPE Tapping Saddle Kit,  
 Low Riser 15mm Female BSP

EA

#### **IRRW32H15FM**

White Pod Cover, Black Base, 32mm LDPE Tapping Saddle Kit,  
 High Riser 15mm Female BSP

EA

#### **IRRW40LACME**

White Pod Cover, Black Base, 40mm LDPE Tapping Saddle Kit,  
 Low Riser ACME

EA

#### **IRRW40L15FM**

White Pod Cover, Black Base, 40mm LDPE Tapping Saddle Kit,  
 Low Riser 15mm Female BSP

EA

#### **IRRW40L20M**

White Pod Cover, Black Base, 40mm LDPE Tapping Saddle Kit,  
 Low Riser 20mm Male BSP (Inc SS20)

EA

#### **IRRW40H15FM**

White Pod Cover, Black Base, 40mm LDPE Tapping Saddle Kit,  
 High Riser 15mm Female BSP

EA

#### **IRRW45L15FM**

White Pod Cover, Black Base, 45mm LDPE Tapping Saddle Kit,  
 Low Riser 15mm Female BSP

EA

#### **IRRW45L20M**

White Pod Cover, Black Base, 45mm LDPE Tapping Saddle Kit,  
 Low Riser 20mm Male BSP (Inc SS20)

EA

#### **IRRW45H15FM**

White Pod Cover, Black Base, 45mm LDPE Tapping Saddle Kit,  
 High Riser 15mm Female BSP

EA



## Complete Irripod



**Complete Black Irripod  
Includes Tapping Saddle  
Kits & Sprinkler Riser  
(Sprinkler Sold  
Separately)**

### Code & Description

**Pack  
Size**  
EA

#### IRRB32LACME

Black Pod Cover, Black Base, 32mm LDPE Tapping saddle kit,  
Low Riser ACME

#### IRRB32L15FM

Black Pod Cover, Black Base, 32mm LDPE Tapping saddle kit,  
Low Riser 15mm Female BSP

EA

#### IRRB32H15FM

Black Pod Cover, Black Base, 32mm LDPE Tapping saddle kit,  
High Riser 15mm Female BSP

EA

#### IRRB40LACME

Black Pod Cover, Black Base, 40mm LDPE Tapping saddle kit,  
Low Riser ACME

EA

#### IRRB40L15FM

Black Pod Cover, Black Base, 40mm LDPE Tapping saddle kit,  
Low Riser 15mm Female BSP

EA

#### IRRB40L20M

Black Pod Cover, Black Base, 40mm LDPE Tapping saddle kit,  
Low Riser 20mm Male BSP (Inc SS20)

EA

#### IRRB40H15FM

Black Pod Cover, Black Base, 40mm LDPE Tapping saddle kit,  
High Riser 15mm Female BSP

EA

#### IRRB45L15FM

Black Pod Cover, Black Base, 45mm LDPE Tapping saddle kit,  
Low Riser 15mm Female BSP

EA

#### IRRB45L20M

Black Pod Cover, Black Base, 45mm LDPE Tapping saddle kit,  
Low Riser 20mm Male BSP (Inc SS20)

EA

#### IRRB45H15FM

Black Pod Cover, Black Base, 45mm LDPE Tapping saddle kit,  
High Riser 15mm Female BSP

EA



**Complete Lilac Irripod  
Includes Tapping Saddle  
Kits & Sprinkler Riser  
(Sprinkler Sold  
Separately)**

### Code & Description

**Pack  
Size**  
EA

#### IRRL45L20M

Lilac Pod Cover, Black Base, 45mm LDPE Tapping Saddle Kit,  
Low Riser 20mm Male BSP (Inc SS20)

## Body and Base



IRRIPOD



### Code & Description

#### IRRIPOD-BL

Black Pod Cover & Black Base to suit 32,40,45mm Pipe

Pack  
Size  
EA



#### IRRIPOD-WH

White Pod Cover & Black Base to suit 32,40,45mm Pipe

EA



#### IRRIPOD-LI

Lilac Pod Cover & Black Base to suit 45mm Effluent Pipe

EA

## Tapping Saddle Kits To Suit 32, 40 or 45mm Pod Pipe



### Code & Description

#### TSK32-40LDU

Tapping Saddle Kit to suit 32-40mm LD Pipe with U-Bolts

Pack  
Size

EA

#### TSK40-45LDU

Tapping Saddle Kit to suit 40-45mm LD Pipe with U-Bolts

EA

*Irripod U-Bolt Tapping Saddle Kits for 32, 40 or 45mm LDPE Pipe contains:*

*1 x Cross Tee Anchor*

*1 x Wire Protector*

*2 x Wire Retainer Clips*

*1 x Irripod Tapping Saddle Seal*

*Irripod U-Bolt Bag (2 x M8 x 65mm Stainless Steel U Bolts, 4 x M8 Stainless Steel Flanged Nuts)*

*1 x Irripod Screw Bag (6 x 10g Pozi Pan Head Self Tapping Stainless Steel Screws)*



### Code & Description

#### TSK40-45USS

Tapping Saddle Kit 40-45mm with U-Bolts & Stainless Steel Bar

Pack  
Size

EA

*Irripod U Bolt Tapping Saddle Kit for 40 or 45mm LDPE Pipe with a Stainless Steel Wire Protector contains:*

*1 x Cross Tee Anchor 40-45mm LDPE*

*1 x Stainless Steel Wire Protector*

*2 x Wire Retainer Clips*

*1 x Irripod Tapping Saddle Seal*

*Irripod U Bolt Bag (2 x M8 x 65mm Stainless Steel U Bolts, 4 x M8 Stainless Steel Flanged Nuts)*

*1 x Irripod Screw Bag (6 x 10g Pozi Pan Head Self Tapping Stainless Steel Screws)*



## Tapping Saddle Kits To Suit 32, 40 or 45mm Pod Pipe

...continued from previous page



### Code & Description

#### POPKIT40LDU

40mm Pop Up Tapping Saddle Kit with U-Bolts

**Pack Size**

EA

*Irripod Pop Up Tapping Saddle Kit for 40mm LDPE Pipe contains:*

- 1 x Cross Tee Anchor 32-40mm LDPE
- 1 x Pop Up Tapping Saddle Body 40mm LDPE
- 1 x Pop Up Piston
- 1 x Pop Up Screw Cap
- 1 x Pop Up Pod Cover
- 1 x Pop Up Screw Cap Seal
- 2 x Wire Retainer Clips
- 1 x Irripod Tapping Saddle Seal
- 1 x Irripod Wire Protector
- 1 x O-Ring
- 1 x Irripod U Bolt Bag (2 x M8 x 65mm Stainless Steel U Bolts, 4 x M8 Stainless Steel Flanged Nuts)
- 1 x Irripod Screw Bag (6x10g, 4x6g Pozi Pan Head Self Tapping Stainless Steel Screws)



### Code & Description

#### SINGLEKITU

20mm Single Pod Kit BSP with U-Bolts

**Pack Size**

EA

*Irripod Single Pod Tapping Saddle Kit for 20mm LDPE Pipe contains:*

- 1 x Handle 20mm Female x 25mm Male
- 2 x Wire Retainer Clips
- 1 x 20mm Hansen Socket
- 1 x 20mm Hansen Hex Nipple
- 1 x Irripod Wire Protector
- 1 x Irripod Screw Bag (6x10g, 2 x 12g Pozi Pan Head Self Tapping Stainless Steel Screws)
- 1 x Irripod U Bolt Bag (2 x M8 x 65mm Stainless Steel U Bolts, 4 x M8 Stainless Steel Flanged Nuts)



## Hydro Tapping Saddle Kits

### Hydropod Tapping Saddle Kit



### Code & Description

#### TSKHYDROU

Tapping Saddle Kit Hydro 32-40mm LD U-Bolt

**Pack Size**

EA

*Hydropod U Bolt Tapping Saddle Kit contains:*

- 1 x Cross Tee Anchor 32-40mm LDPE
- 1 x Irripod Tapping Saddle Seal
- 1 x Irripod U Bolt Bag (2 x M8 x 65mm Stainless Steel U Bolts, 4 x M8 Stainless Steel Flanged Nuts)

## Tapping Saddle Tops to suit 32, 40 or 45mm Pod Pipe, 15 or 20mm Sprinklers



*For use with Riser to suit Impact or Gear Drive Sprinklers*

### Code & Description

**Pack Size**

**TST32LDL15F**

EA

Tapping Saddle Top 32mm LD Low Riser 15mm Female BSP

**TST40LDL15F**

EA

Tapping Saddle Top 40mm LD Low Riser 15mm Female BSP

**TST45LDL15F**

EA

Tapping Saddle Top 45mm LD Low Riser 15mm Female BSP



*For use with 5022 Nann Impact Sprinkler or Similar*

### Code & Description

**Pack Size**

**TST32LDH15F**

EA

Tapping Saddle Top 32mm LD High Riser 15mm Female BSP

**TST40LDH15F**

EA

Tapping Saddle Top 40mm LD High Riser 15mm Female BSP

**TST45LDH15F**

EA

Tapping Saddle Top 45mm LD High Riser 15mm Female BSP



*For use with Nelson R2000 Sprinkler or Similar*

### Code & Description

**Pack Size**

**TST32LDLAC**

EA

Tapping Saddle Top 32mm LD Low Riser ACME

**TST40LDLAC**

EA

Tapping Saddle Top 40mm LD Low Riser ACME

*Comes with  
1 x O-Ring*



*For use with any 20mm Impact or Gear Drive Sprinklers*

### Code & Description

**Pack Size**

**TST40LDL20M**

EA

Tapping Saddle Top 40mm LD Low Riser 20mm Male BSP

**TST45LDL20M**

EA

Tapping Saddle Top 45mm LD Low Riser 20mm Male BSP

*Comes with  
1 x 20mm Hansen  
Socket*



## Regulator or Riser Spacers



### Code & Description

#### ACME-F-MA

ACME Female BSP Medium Riser

*For use with ACME Low Base with Impact Sprinkler*

**Pack  
Size**  
EA



#### ACME-MF-HA

ACME Male/Female High Riser (comes with O-Ring)

*Use with ACME Low Base, replaces Nelson regulator*

EA



#### ACME-MM-LA

ACME Male/Male BSP Low Riser (comes with O-Ring)

*Converts BSP Low Base to ACME Thread*

EA



## Pod Pipe



### Code & Description

#### IP32100

32mm LDPE Pipe, 100 metres

**Pack  
Size**  
EA

#### IP32200

32mm LDPE Pipe, 200 metres

EA

#### IP40100

40mm LDPE Pipe, 100 metres

EA

#### IP40200

40mm LDPE Pipe, 200 metres

EA

#### IRRIPOD45100

45mm LDPE Pipe, 100 metres

EA

#### IRRIPOD45200

45mm LDPE Pipe, 200 metres

EA



#### 2230.45.PN5.100

45mm Effluent Pipe, 100 metres

EA

#### 2230.45.PN5.200

45mm Effluent Pipe, 200 metres

EA

## Irripod Lifestyle 32 Pack

*Irripod Lifestyle 32 Pack is a flexible, cost effective pipeline sprinkler irrigation system. This pack is best suited for blocks of land with smaller paddock sizes up to 1 hectare. It's well suited to both conventional shaped paddocks as well as irregular and rolling type country due to it's flexible nature, making it adaptable to suit the many different size and shaped properties.*



### Code & Description

**IRRIPOD2PACK\*** Lifestyle 32 Two Pod 25 Metre Pack

**Pack Size**

EA

*Irripod Lifestyle 32 Two Pod Pack contains:*

- 2 x Black Pod and Base
- 2 x Naan 5035 SD Sprinkler with 4.0mm Nozzle
- 2 x Wire Protector
- 4 x Wire Retainer Clips
- 2 x Cross Tee Anchor 32-40 LDPE
- 2 x 32mm LD Low Riser 20mm Male BSP with O-Ring
- 2 x 20mm Hansen Hex Socket
- 1 x 32mm Hansen Female Straight
- 1 x 32mm Hansen Tow Eye
- 2 x Irripod Screw Bag (6 x 10g, 2x12g Pozi Pan Head Self Tapping Stainless Steel Screws)
- 2 x Irripod U Bolt Bag (2 x M8 x 65mm Stainless Steel U Bolts, 4 x M8 Stainless Steel Flanged Nuts)
- 1 x 2 Meter Tow Rope
- 1 x 32mm x 25 Meter LDPE Pipe
- 1 x 15mm Drill Bit
- 1 x Screw Bit
- 1 x 13mm Ring Spanner
- 1 x Ceelon Red tape

*\*Non stock item, available on request*



### Code & Description

**IRRIPOD4PACK\*** Lifestyle 32 Four Pod 50 Metre Pack

**Pack Size**

EA

*Irripod Lifestyle 32 Four Pod Pack contains:*

- 4 x Black Pod and Base
- 4 x Naan 5035 SD Sprinkler with 3.5mm Nozzle
- 4 x Naan 4.0mm Nozzle
- 4 x Wire Protector
- 8 x Wire Retainer Clips
- 4 x Cross Tee Anchor 32-40 LDPE
- 4 x 32mm LD Low Riser 20mm Male BSP with O-Ring
- 4 x 20mm Hansen Hex Socket
- 1 x 32mm Hansen Female Straight
- 1 x 32mm Hansen Tow Eye
- 4 x Irripod Screw Bag (6 x 10g, 2x12g Pozi Pan Head Self Tapping Stainless Steel Screws)
- 4 x Irripod U Bolt Bag (2 x M8 x 65mm Stainless Steel U Bolts, 4 x M8 Stainless Steel Flanged Nuts)
- 1 x 2 Meter Tow Rope
- 1 x 32mm x 50 Meter LDPE Pipe
- 1 x 15mm Drill Bit
- 1 x Screw Bit
- 1 x 13mm Ring Spanner
- 1 x Ceelon Red tape

*\*Non stock item, available on request*



## Retail Packs

### Irripod Single Pod 25 Metre Kit

*Irripod Single Pod Kit is a versatile, strong, portable Sprinkler Irrigation System. The Single Pod sprinkler is ideally suited to fit in small paddocks or irregular shaped areas where it is difficult to fit traditional irrigation systems. Irripod Single Pod Sprinkler is designed to operate off a standard 19mm garden hose or 20mm Polyethylene Pipe, has a coverage area of 500 sqm and an intensity rate of 2.6mm per hour, with the ability to operate at very low pressures (3 Bar).*



#### Code & Description

**SINGLE25M** Single Pod 25 Metre Kit

#### Pack Size

EA

*Irripod 25 Metre Single Pod Kit contains:*

- 1 x Black Pod and Base
- 1 x Naan 5035 SD Sprinkler
- 1 x Wire Protector
- 2 x Wire Retainer Clips
- 1 x Handle 20mm Female x 25mm Male
- 1 x 25mm Hansen Female Straight
- 1 x 20mm Hansen Hex Socket
- 1 x 20mm Hansen Hex Nipple
- 1 x Irripod Screw Bag (6 x 10g, 2x12g Pozi Pan Head Self Tapping Stainless Steel Screws)
- 1 x Irripod U Bolt Bag (2 x M8 x 65mm Stainless Steel U Bolts, 4 x M8 Stainless Steel Flanged Nuts)

### Irripod Multi Fit Single Pod Kit

*Irripod Multi Fit Single Pod Kit is a flexible, cost effective Irrigation Pod Skid that can be used as a replacement Pod or as an extension to existing sprinkler irrigation systems. Designed to fit 32mm or 40mm LDPE pipe and to accommodate all LDPE fitting and sprinkler configurations.*



#### Code & Description

**MULTIPOD** Multi Fit Single Pod Kit

#### Pack Size

EA

*Irripod Multi Fit Single Pod Kit contains:*

- 1 x Black Pod and Base
- 1 x Wire Protector
- 2 x Wire Retainer Clips
- 1 x Irripod Tapping Saddle Seal
- 1 x Cross Tee Anchor 32-40 LDPE
- 1 x 32mm ACME Tapping Saddle Top
- 1 x 40mm ACME Tapping Saddle Top
- 1 x 32mm ACME LD Low Riser with O-Ring
- 1 x 15mm x 15mm ACME Male/Female High Riser with O-Ring
- 1 x 15mm x 15mm ACME Female BSP Medium Riser
- 1 x Irripod U Bolt Bag (2 x M8 Stainless Steel U Bolts, 4 x M8 Stainless Steel Flanged Nuts)
- 1 x Irripod Screw Bag (6x10g Pozi Pan Head Self Tapping Stainless Steel Screws)

## Effluent System



### Code & Description

#### EFFLUENTSYS

Effluent System Part A,B,C,D

**Pack Size**  
EA

*Effluent System Set contains:*  
 1 x Part A - 90mm Adaptor Set  
 1 x Part B - Sub Main Set  
 1 x Part C - Pod Hydrants  
 3 x Part D - Pod Sprinkler Lines



### Code & Description

#### EFFLUENT-A

Effluent 90mm Adaptor

**Pack Size**  
EA

*Irripod Effluent 90mm Adaptor Set is used to attach a 90mm Effluent Pipeline to the 45mm Sub Main Set (Part B)*  
 Contains:

1 x Hansen 80mm Male Camlock Threaded Adaptor  
 1 x Hansen 100mm Female Elbow  
 1 x Hansen 100 x 50mm Reducing Bush  
 1 x Hansen 100 x 80mm Reducing Bush  
 2 x Hansen 50mm Hex Nipples  
 1 x Hansen 50mm Lilac Ball Valve  
 1 x 50mm Female Camlock PP  
 2 x 1/2" Thread Tape

*Packaging 1 x Box*



### Code & Description

#### EFFLUENT-B

Effluent Sub Main Set

**Pack Size**  
EA

*Irripod Effluent Sub Main Set is used to attach to the Adaptor Set (Part A)*  
 Contains:

2 x Hansen 45mm Camlock with Lilac Nut  
 1 x 50mm Female Camlock PP  
 1 x Hansen 50mm Tow Eye BSPT  
 1 x Effluent Pipe 45mm x 50m Lilac coded  
 1 x Yellow Tow Ball  
 1 x Tow Rope 2 metre spliced ends  
 2 x 1/2" Thread Tape

*Packaging 1 x Box & 1 x Coil of Pipe*



## Effluent System

...continued from previous page



### Code & Description

#### EFFLUENT-C

Effluent Pod Hydrants

**Pack Size**

EA

*Irripod Effluent Pod Hydrants are attached to the Effluent Pipe at 20m intervals to distribute the Effluent to the Pod Sprinkler Lines.*

*Contains:*

- 3 x Irripod Low Bases*
- 12 x M8 x 25 Stainless Steel Cap Screws*
- 3 x Hansen Manifold Block 50mm 4 Way BSP*
- 6 x Hansen 50mm Hex Nipples*
- 6 x Hansen 45mm Male Straight Coupling with Lilac Nut*
- 6 x Hansen 50mm Lilac Ball Valves BSP*
- 6 x 50mm Male Camlock PP*
- 3 x 1/2" Thread Tape*

*Packaging 1 x Box*



### Code & Description

#### EFFLUENT-D

Effluent Pod Lines

Part D - Pod Sprinkler Lines

**Pack Size**

EA

*Irripod Effluent Pod Sprinkler Lines are attached to the Effluent Pipe at 20m intervals to distribute the Effluent.*

*Contains:*

- 6 x Lilac Pods with Black Bases*
- 6 x 20mm Naan 5035 SD Sprinklers*
- 6 x Irripod 45mm LDPE Low Riser 20mm Male BSP Tapping Saddle Tops*
- 6 x Hansen 20mm Sockets*
- 2 x Hansen 45mm Camlock with Lilac Nut*
- 1 x 50mm Female Camlock PP*
- 1 x Hansen 50mm Tow Eye BSPT*
- 1 x Irripod Effluent Pipe 45mm x 120m Lilac coded*
- 1 x Yellow Tow Ball*
- 1 x Tow Rope 2 Metre Spliced Ends*
- 6 x Cross Tee Anchor 40-45mm LDPE*
- 6 x Wire Protectors*
- 12 x Wire Retainer Clips*
- 6 x Tapping Saddle Seals*
- 6 x Irripod Screw Bags (6 x 10g Pozi Pan Head Self Tapping Stainless Steel Screws)*
- 6 x Irripod U-Bolt Bags (2 x M8 x 65mm Stainless Steel U Bolts, 4 x M8 Stainless Steel Flanged Nuts)*

*Packaging 1x Box and 1x Coil of 45mm Effluent Pipe*

## Accessories



*For use with LDPE Poly Pod Pipe.*



**Tow Eye**  
Poly x Tow Eye  
LDPE Pipe

| Code    | Description            | Pack Size |
|---------|------------------------|-----------|
| PODTE32 | 32mm Tow Eye LDPE Pipe | EA        |
| PODTE40 | 40mm Tow Eye LDPE Pipe | EA        |
| PODTE45 | 45mm Tow Eye LDPE Pipe | EA        |



**Tow Eye**  
BSPT x Tow Eye

| Code       | Description               | Pack Size |
|------------|---------------------------|-----------|
| PODTE45/50 | 50mm BSP Threaded Tow Eye | EA        |



**Tow Eye**  
NPT x Tow Eye

| Code           | Description               | Pack Size |
|----------------|---------------------------|-----------|
| PODTE45/50NPT* | 50mm NPT Threaded Tow Eye | EA        |

*\* NPT Products are a non stock item, available on request*

*For use with LDPE Poly Pod Pipe.*



**Straight Coupling**  
Poly x Poly

| Code | Metric      | Imperial        | Pack Size |
|------|-------------|-----------------|-----------|
| HS32 | 32mm x 32mm | 1 1/4" x 1 1/4" | EA        |
| HS40 | 40mm x 40mm | 1 1/2" x 1 1/2" | EA        |
| HS45 | 45mm x 45mm | 1 3/4" x 1 3/4" | EA        |

*For use with LDPE Poly Pod Pipe.*



**Reducing Straight Coupling**  
Poly x Poly

| Code    | Metric      | Imperial        | Pack Size |
|---------|-------------|-----------------|-----------|
| HRS4032 | 40mm x 32mm | 1 1/2" x 1 1/4" | EA        |
| HRS4540 | 45mm x 40mm | 1 3/4" x 1 1/2" | EA        |

*For use with LDPE Poly Pod Pipe.*



**Male Straight Coupling**  
BSPT x Poly

| Code  | Metric      | Imperial        | Pack Size |
|-------|-------------|-----------------|-----------|
| HMS32 | 32mm x 32mm | 1 1/4" x 1 1/4" | EA        |
| HMS40 | 40mm x 40mm | 1 1/2" x 1 1/2" | EA        |
| HMS45 | 50mm x 45mm | 2" x 1 3/4"     | EA        |



## Accessories

### Female Straight Coupling BSPT x Poly



| Code            | Metric          | Imperial            | Pack Size |
|-----------------|-----------------|---------------------|-----------|
| <b>HFS32</b>    | 32mm x 32mm     | 1 1/4" x 1 1/4"     | EA        |
| <b>HFS40</b>    | 40mm x 40mm     | 1 1/2" x 1 1/2"     | EA        |
| <b>HFS40NPT</b> | 40mm x 40mm NPT | 1 1/2" x 1 1/2" NPT | EA        |

*NPT Products are a non stock item, available on request*

*Fits Aluminium & Polypropylene Camlocks. The Hansen 45mm Camlock fits the Irripod 45mm Pipe System.*

### Male Camlock Male Camlock x Poly



| Code          | Metric | Imperial | Pack Size |
|---------------|--------|----------|-----------|
| <b>HCEP32</b> | 32mm   | 1 1/4"   | EA        |
| <b>HCEP40</b> | 40mm   | 1 1/2"   | EA        |
| <b>HCEP45</b> | 45mm   | 1 3/4"   | EA        |

### Lilac Nut



| Code           | Metric | Imperial | Pack Size |
|----------------|--------|----------|-----------|
| <b>HPNL45*</b> | 45mm   | 1 3/4"   | EA        |

*\*Non stock item, available on request*



White Irripod 40mm system running

Parts

| <b>Cross Tee Anchor</b> | <b>Code &amp; Description</b> | <b>Pack Size</b> |
|-------------------------|-------------------------------|------------------|
|                         | <b>CTA32-40LD</b>             | EA               |
|                         | Cross Tee Anchor 32-40mm LDPE |                  |
|                         | <b>CTA40-45LD</b>             | EA               |
|                         | Cross Tee Anchor 40-45mm LDPE |                  |



| <b>Manifold</b> | <b>Code &amp; Description</b>  | <b>Pack Size</b> |
|-----------------|--|------------------|
|                 | <b>MANIFOLD</b>  | EA               |
|                 | 50mm Manifold 4 Way BSP  |                  |
|                 | <b>MANIFOLDNPT*</b>  | EA               |
|                 | 50mm Manifold 4 Way NPT  |                  |
|                 | <b>MANIFOLD25M</b>   | EA               |
|                 | 50mm Manifold 5 Way BSP includes 25mm BSPT Thread Hole in Top Spigot |                  |



*\*Non stock item, available on request*

**Irripod Pop Up Parts**

**Pop Up Screw Cap**



| <b>Code &amp; Description</b>   | <b>Pack Size</b> |
|---------------------------------|------------------|
| <b>POPCAP</b>                   | EA               |
| Pop Up Tapping Saddle Screw Cap |                  |

**Pop Up Pod Cover**



| <b>Code &amp; Description</b> | <b>Pack Size</b> |
|-------------------------------|------------------|
| <b>POPCOVER</b>               | EA               |
| Pop Up Pod Cover              |                  |



## Parts

### Pop Up Piston



### Code & Description

**POPPISTON**

Pop Up Piston with O-Ring Seal ACME Thread

### Pack Size

EA

### Pop Up Screw Cap Seal



### Code & Description

**POPSEAL**

Pop Up Tapping Saddle Screw Cap Seal

### Pack Size

EA

### Pop Up Tapping Saddle Top



### Code & Description

**TST40LDPOP**

40mm LDPE Pop Up Tapping Saddle Top

### Pack Size

EA

## Irripod Covers & Bases



### Code & Description

**IP-COVER-BL**

Black Pod Cover

### Pack Size

EA



**IP-COVER-LI**

Lilac Pod Cover

EA



**IP-COVER-WH**

White Pod Cover

EA



**IP-BASE-BLK**

Black Base for 32mm, 40mm and 45mm Pipe

EA



**IP-LOWBASE**

Black Low Base for 45mm Effluent Pipe  
For use in Effluent Pack Part C

EA

## Irripod Wire Protectors

*Protects Pods and Sprinklers from damage*



### Code & Description

### Pack Size

#### IP-WIRE

EA

Wire Protector

#### IP-WIRE-SS

EA

Wire Protector Stainless Steel

#### IP-WIRECLIP

EA

Wire Retainer Clip

## Irripod Bolts, Screws, Seals & U Bolts

*Irripod Screw Bag*



### Code & Description

### Pack Size

#### IP-SCREWS

EA

Irripod Screw Bag

*1 x Irripod Screw Bag (6 x10g Pozi Pan Head Self Tapping Stainless Steel Screws)*



### Code & Description

### Pack Size

#### IP-SEAL

EA

Tapping Saddle Seal 24.99mm ID x 3.53mm



### Code & Description

### Pack Size

#### IP-UBOLTS

EA

U -Bolt Bag

*1 x Irripod U-Bolt Bag (2 x M8 x 65mm Stainless Steel U Bolts, 4 x M8 Stainless Steel Flanged Nuts)*



### Code & Description

### Pack Size

#### HANDLE25

EA

20mm Single Pod Handle Female BSP



## Accessories

### Fence Signs



| Code          | Description                            | Pack Size |
|---------------|--|-----------|
| <b>SIGN1</b>  | 240mm Movement Fence Sign Yellow No 1  | EA        |
| <b>SIGN2</b>  | 240mm Movement Fence Sign Yellow No 2  | EA        |
| <b>SIGN3</b>  | 240mm Movement Fence Sign Yellow No 3  | EA        |
| <b>SIGN4</b>  | 240mm Movement Fence Sign Yellow No 4  | EA        |
| <b>SIGN5</b>  | 240mm Movement Fence Sign Yellow No 5  | EA        |
| <b>SIGN6</b>  | 240mm Movement Fence Sign Yellow No 6  | EA        |
| <b>SIGN7</b>  | 240mm Movement Fence Sign Yellow No 7  | EA        |
| <b>SIGN8</b>  | 240mm Movement Fence Sign Yellow No 8  | EA        |
| <b>SIGN9</b>  | 240mm Movement Fence Sign Yellow No 9  | EA        |
| <b>SIGN10</b> | 240mm Movement Fence Sign Yellow No 10 | EA        |
| <b>SIGN11</b> | 240mm Movement Fence Sign Yellow No 11 | EA        |
| <b>SIGN12</b> | 240mm Movement Fence Sign Yellow No 12 | EA        |
| <b>SIGN13</b> | 240mm Movement Fence Sign Yellow No 13 | EA        |
| <b>SIGN14</b> | 240mm Movement Fence Sign Yellow No 14 | EA        |



### Tow Balls

#### Code & Description

##### TOWBALL

Tow Trailer Tow Ball Yellow

**Pack Size**

EA

### Tow Rope

#### Code & Description

##### TOWROPE

Tow Rope 2 Metre Spliced Ends

**Pack Size**

EA

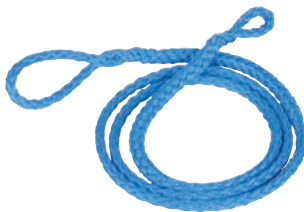

### Tow Trailer

*Irripod Tow Trailers have been designed to enable the easy movement of your Irripod Irrigation or Effluent Systems. The Irripod Tow Trailer features a quick release mechanism that allows the shift to be completed without having to leave the Tow Vehicle.*

#### Code & Description

##### TOWTRAILER

Irripod Tow Trailer

**Pack Size**

EA





# Irrigation System

For all Technical Irripod Irrigation  
queries please either phone or email  
our Irripod Market Manager

Nigel Henigan  
Mobile: + 64 21 963 432  
Email: [nigel.henigan@irripod.com](mailto:nigel.henigan@irripod.com)

# What is Irripod Irrigation?

Irripod Plus is a flexible, cost effective pipeline sprinkler irrigation system for pasture and forage crops.

Designed to operate at low pressure Irripod Plus distributes water on a slow absorption rate over a 12-24 hour period. This allows for effective absorption into the soil whilst eliminating pooling and run off. The system only requires movement once per 12-24 hour period.

Irripod Plus is a component system that is simple to install and manage. The system utilises protective Pod Skid covers over sprinklers that are attached to an irrigation pipeline. Irripod Plus can be configured to suit individual requirements dependent on application rates, the distance to be irrigated and

the rotation intervals appropriate for the situation. Each Irripod irrigation line can be customised to suit varying paddock sizes and shapes while also accommodating existing obstructions.

Irripod irrigation lines are strong, lightweight, flexible and easily moved while the system is operating by attaching the lines to an ATV or farm vehicle.

The flexibility of Irripod Plus means the system can be configured for many different end uses in addition to traditional pasture and forage crop irrigation; these include orchards, golf courses, sports fields, race tracks, dust suppression in developing housing subdivisions and bush fire protection.

## Multiple Configuration Options



Irripod Pop-Up Pod



Irripod Lilac Effluent System



Irripod Plus High Visibility Pod



Irripod DIY Black Pod

The Irripod Systems in this catalogue are protected by intellectual property rights owned by the Hansen group of companies in New Zealand. For more information refer to the legal information section.

## Advantages of Irripod Plus Systems

### Lower Cost of Ownership

- Allows irrigation of more marginal land.
- Simple to add to irrigation scheme as funding allows.
- Low pressure system translates into lower running costs.
- Only requires one person to shift the lines.

### Simple Technology

- Easy to understand and manage.
- Does not require specialist skills or tools.

### Efficient Water Application

- Low sprinkler height means less wind drift and effective water distribution pattern.
- Mimics natural rainfall allowing for efficient soil water absorption and less runoff.
- Smaller droplet size means less soil compaction.

### Versatile

- Able to be used on flat or rolling country and with odd shaped fields.
- Able to be turned on and off without waiting for the irrigation cycle to be completed.
- The system can be left on while livestock are in the field.



## Reasons to Specify Irripod Plus

### Innovative Robust Design

- Fittings prevent the Pod unit from slipping or twisting on the pipe.
- Wire protection Bar across the top of the Pod provides sprinkler protection against mechanical damage when shifting lines as well as damage from stock.

### In Line and Single Pod Component System

- Assembly of the sprinkler to the Pod Skid Base prior to the Pod cover being attached saves on installation time.
- The two piece Irripod can be replaced without cutting or rethreading the pipeline.

### Multiple Configuration Options

- Irripod accommodates multiple sprinkler sizes and 32mm (1 1/4"), 40mm (1 1/2") or 45mm (1 3/4") irrigation pipe sizing.

### 'Pop-Up' Sprinkler Option for 40mm (1 1/2")

- Prevents hoof and leg injury in young stock and sprinkler damage from inquisitive stock.
- Incorporates Nelson R2000 sprinkler with options to regulate.

### 45mm System

- Designed to operate on High Volume 45mm (1 3/4") Irrigation pipe.
- Incorporates 20mm (3/4") sprinklers, allowing for greater coverage and higher water volumes.

### Effluent System

- Irripod Effluent Systems distribute liquid effluent on a slow absorption rate.
- Irripod Effluent Systems incorporates 45mm (1 3/4") design technology.
- Internationally recognised Lilac colouring depicting effluent dispersal.

### Quality Materials

- High impact UV resistant plastic construction coupled with long life corrosion proof fastenings.

### Operating Guidelines

#### Irripod Plus System Management

- Moving Times – 12 or 24 hours, dependent upon system design.
- Return Times – Range from 8 to 14 days and are determined by soil structure, pasture/crop type, water availability and local climate conditions.

#### Moving Irrigation Lines

Irripod Plus lines have been designed to be moved whilst still operating. The system can be moved simply and safely with very little effort.

- Movement is typically done by an ATV. Do not exceed ATV manufacturer's recommendations for maximum towing weight.
- Use markers on the fence to align the irrigation line movements at required increments.
- Picking up irrigation lines is done using the Hansen Tow Hook and Tow Rope which is secured to the ATV or other farm vehicle.
- Ensure the ATV or farm vehicle is facing the direction the line is to be towed.
- In one smooth movement proceed to skid the Feed/Sprinkler line towards the marker sign at the other end of the field, keeping the line within a couple of meters of its self for as long as possible to prevent pod rollover. Once line is in place unhook and proceed to next line.

See example below of an Entire Movement Rotation of your Irripod System

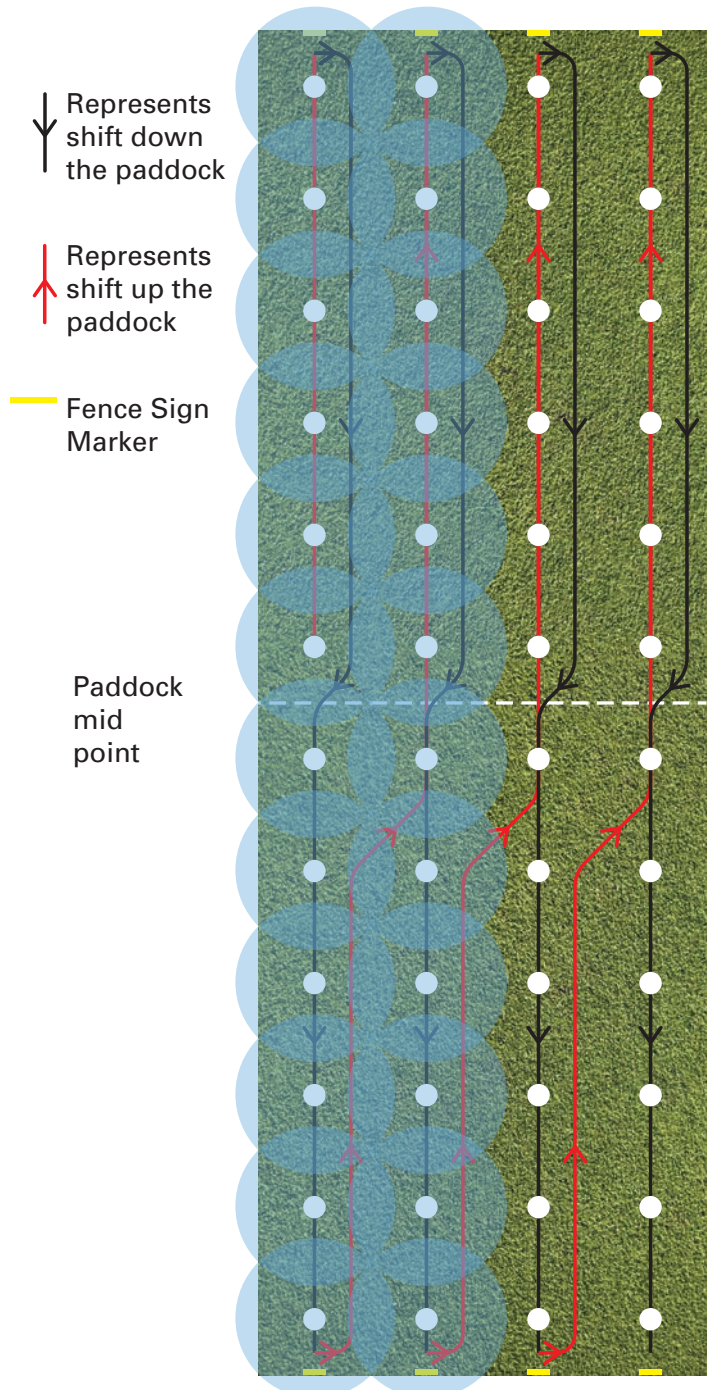

## Example of Moving an Irripod System Steps 1 and 2

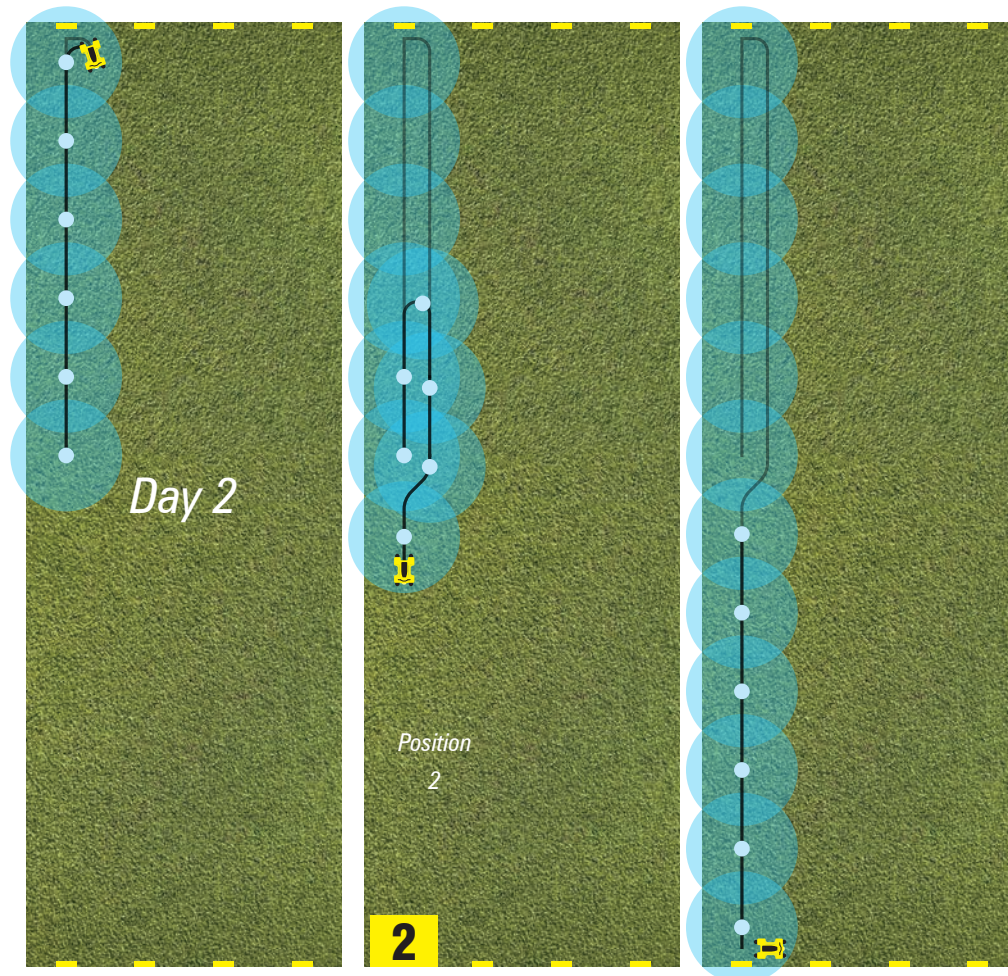

**The aim when moving a sprayline to its next position in the rotation is to minimise the incidents of roll-over. Even though the sprinkler is protected from roll-over it can still be damaged. Also roll-over can cause twisting of the Pod pipe.**

1. Approach the end of the sprayline at an angle that will allow you to move back down the sprayline at a distance of around 1-2 metres parallel to that sprayline.  
Too close and the Pods will try to roll – Too far and the Pods will try to roll. (This will become apparent to the person moving the lines).
2. When placing spraylines in even day positions (i.e. 2nd shift – 4th shift etc) when reaching the end of the sprayline move across into correct position and proceed to the end of that system area.

### Example of Moving an Irripod System Steps 3 and 4

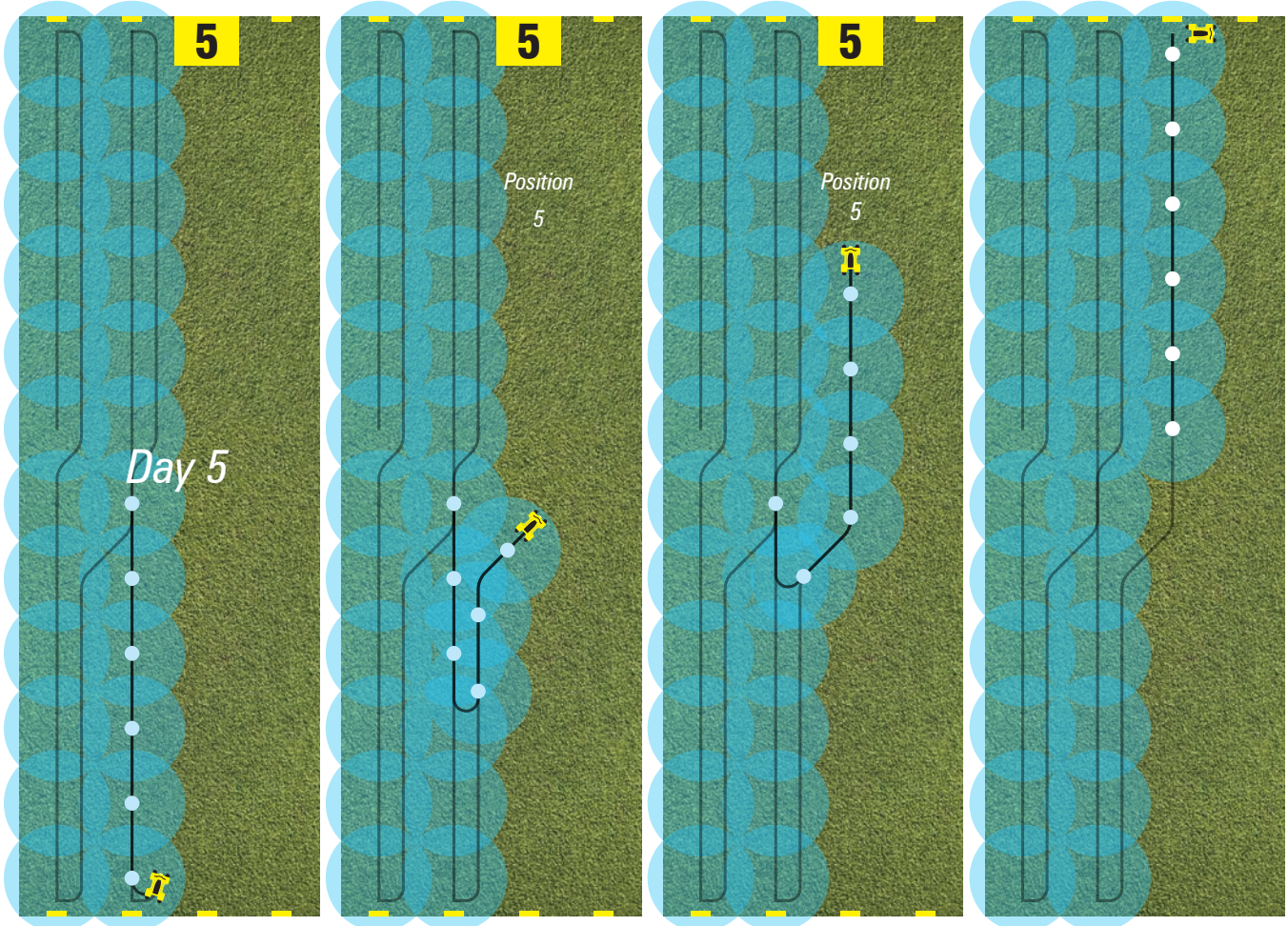

- When placing spraylines in odd day positions (i.e. 3rd shift – 5th shift etc) when reaching a point approximately 2/3rds of the length of that sprayline move out to next system spacing and proceed to the end of that system area.

Again this procedure will become apparent to the person shifting the spraylines, if they are not moving in or out at the correct point they will find the last 1 or 2 Pods will be out of line.

- At the end of the system area rotation (return period) detach the sprayline from the dragline and tow the sprayline back into position 1. Detach the dragline from the hydrant and tow the length of the system area and then back into position and reattach to both hydrant and sprayline.

This will allow any twisting of the dragline that has occurred during rotation to be removed from pipe.

## Irripod Pop Up Sprinkler Pods

Irripod 40mm Pop-Up Pod is a flexible, cost effective pipeline sprinkler irrigation system for pasture and forage crops, designed to operate at low pressure and distribute water on a slow absorption rate over a 12-24-hour period. This allows for effective absorption into the soil whilst eliminating pooling and run off. The system utilises protective Pod Skid covers over sprinklers that are attached to an irrigation pipeline. Irripod Pop-Up Pod can be configured to suit individual requirements dependent on application rates, the distance to be irrigated and the rotation intervals appropriate for the situation. Each Irripod irrigation line can be customised to suit varying paddock sizes and shapes while also accommodating existing obstructions.

Irripod In-Line Pop-Up Pod incorporates a Pop-Up protected sprinkler. The cover protecting the sprinkler also protects young and inquisitive stock from leg damage by allowing no access into the Pod body. The Irripod In-Line Pop-Up Pod is designed for use with Nelson R2000WF sprinkler series with the ability to incorporate the Nelson Mini Regulator.

## Operating Guidelines

- Moving Times – 12 or 24 hours, dependent upon system design.
- Return Times – Range from 8 to 14 days and are determined by soil structure, pasture/crop type, water availability and local climate conditions.



Pop Up Sprinkler down i.e. Not in use.



Pop Up Sprinklers in use while horses are in the paddock.

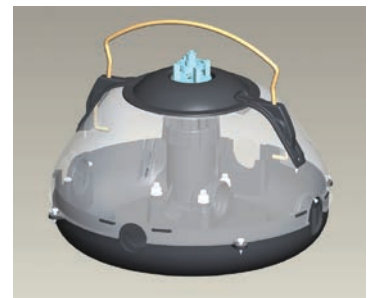

Pop Up Sprinkler up i.e. In use.

### Installing Irripod Pop Up Pods

**Note: Pipe needs to be laid out at least 24 hours before installation of pods.**

**Step 1** Begin your installation at the far end of the pod line where the Tow Eye will be fitted (do not fit Tow Eye until line is flushed).

**Step 2** Mark a position that is 1m from the end of the line. This is where you will install the first Pod Skid.

**Step 3**



Lay pipe over Skid Base and secure in position with Cross Tee Anchor.



Drill 15mm (9/16") hole at required spacing for the sprinkler type being used and remove all drilling swarf. Ensure the hole is drilled perpendicular to the Pod Base.



Screw either Nelson Mini Reg or Irripod ACME Male/Female High Riser onto ACME thread in base of Pop-up Piston and then place into Pop-up Tapping Saddle Top.



Place Pop-up Screw Cap Seal on top of Pop-up Tapping Saddle Top and secure Pop-up Screw Cap into place.



Tip the Pop-up TST until Mini Reg or Riser protrude, hold with finger and screw on Nelson R2000WF. Note all threads should be hand tight, do not use a tool for tightening.



Fit O-ring seal to Pop-up Tapping Saddle Top, locate spigot into hole in pipe and fasten to Cross Tee Anchor, ensure fastening nuts are tightened evenly.



Locate body on skid base and push firmly down to engage grip lugs.



Secure top cover by screws around the base.



Fix wire clip into opposing holes on body sides. Ensure the wire runs parallel with the pipe as shown in the image.



Screw wire clip holders into the holes provided.



Locate Pop-up Pod Cover on top of Irripod Top Cover and ensuring the cutouts in the Pop-up Cover locate inline with the Pipe direction, fasten with screws.



Flush the irrigation line prior to fitting the pipeline Tow Eye to remove any drilling debris left in the pipe.

**Step 4** Having completed the assembly of the first Pod Skid, measure along the pipe the sprinkler design spacing from the last Pod Skid. This is where you will place the next Pod Skid. You now need to assemble the Pod (repeat Step 3). When you have completed the assemblies of the Pod simply follow Step 4, and Step 3 until you have completed all Pod Skids required on the particular pod line.

**Step 5** You should now have all the Pod Skids fitted to the Sprinkler line. It is best practice to camlock join the Pod line to the Feedline.

We recommend following pipe manufacturers guidelines.

**Note: Feedlines not to be less than distances from the Hydrant to boundary of spray line area.**

## Installing Inline Irrigation Pod Skids

**Note: Pipe needs to be laid out at least 24 hours before installation of pods.**

### Step 1

Begin your installation at the far end of the pod line where the Tow Eye will be fitted (do not fit Tow Eye until line is flushed).

### Step 2

Mark a position that is 1m from the end of the line. This is where you will install the first Pod Skid.

### Step 3



Lay pipe over Skid Base and secure in position with Cross Tee Anchor.



Drill 15mm (9/16") hole at required spacing for the sprinkler type being used and remove all drilling swarf. Ensure the hole is drilled perpendicular to the Pod Base.



Select the Riser to suit your sprinkler size. Ensure fastening nuts are tightened evenly. Fit O-ring seal to sprinkler riser, locate riser spigot into hole in pipe and fasten the cross tee anchor.



Screw sprinkler into sprinkler riser.



Locate body on skid base and push firmly down to engage grip lugs.



Secure top body by screws around the base.



Fix wire clip into opposing holes on body sides. Ensure the wire runs parallel with the pipe as shown in the image.



Screw wire clip holders into the holes provided.



Flush the irrigation line prior to fitting the pipeline Tow Eye to remove any drilling debris left in the pipe.

### Step 4

Having completed the assembly of the first Pod Skid, measure along the pipe the sprinkler design spacing from the last Pod Skid. This is where you will place the next Pod Skid. You now need to assemble the Pod (repeat Step 3). When you have completed the assemblies of the Pod simply follow Step 4, and Step 3 until you have completed all Pod Skids required on the particular pod line.

### Step 5

You should now have all the Pod Skids fitted to the Sprinkler line. It is best practice to camlock join the Pod line to the Feedline. **Note: Feedlines not to be less than distances from Hydrant to boundary of spray line area.**

We recommend following pipe manufacturers guidelines.

### Irripod In-line Multi Fit

Irripod In-line Multi Fit is a flexible, cost effective irrigation Pod Skid that can be used as a replacement Pod or on an extension to existing sprinkler irrigation systems. Designed to fit 32mm or 40mm LDPE pipe and to accommodate all LDPE fitting and sprinkler configurations. Irripod In-line Multi Fit offers a cost effective alternative for end users. Irripod Multi Fit is simple to install; just follow the step by step instructions.

### Installing Pod Skids (Based on 15M Pod Spacings)



Lay pipe over Skid Base and secure in position with Cross Tee Anchor.



Drill 15mm (9/16") hole at required spacing for the sprinkler type being used and remove all drilling swarf. Ensure the hole is drilled perpendicular to the Pod Base.



Select the Riser to suit your sprinkler size. Ensure fastening nuts are tightened evenly. Fit O-ring seal to sprinkler riser, locate riser spigot into hole in pipe and fasten the cross tee anchor.



Screw sprinkler into sprinkler riser.



Locate body on skid base and push firmly down to engage grip lugs.



Secure top body by screws around the base.



Fix wire clip into opposing holes on body sides. Ensure the wire runs parallel with the pipe as shown in the image.



Screw wire clip holders into the holes provided.



Flush the irrigation line prior to fitting the pipeline end cap to remove any drilling debris left in the pipe.

We recommend following pipe manufacturers guidelines.

### Pack Includes:

| Irripod Code | Description                    | Qty | Irripod Code | Description                 | Qty |
|--------------|--------------------------------|-----|--------------|-----------------------------|-----|
| CTA32-40LDPE | Cross Tee Anchor 32-40 LDPE    | 1   | IP-BASE-BK   | Irripod Black Base          | 1   |
| TST32LDLAC   | 32mm LD Low Riser ACME         | 1   | IP-COVER-BL  | Irripod Black Top Cover     | 1   |
| TST40LDLAC   | 40mm LD Low Riser ACME         | 1   | IP-WIRE      | Irripod Wire Protector      | 1   |
| ACME-MF-HA   | Acme Male-Female High Adaptor  | 1   | IP-WIRECLIP  | Irripod Wire Retainer Clips | 2   |
| ACME-F-MA    | Acme-BSP Female Medium Adaptor | 1   | IP-BOLTS     | Irripod Bolt Bag            | 1   |
|              |                                |     | IP-SCREWS    | Irripod Screw Bag           | 1   |
|              |                                |     | IP-SEAL      | Irripod Tapping Saddle Seal | 1   |

### Installing Irripod Lifestyle 32 Two & Four Pod Packs

Irripod Lifestyle 32 Pack is best suited for blocks of land with smaller paddock sizes up to 1 hectare.

**Note: Pipe needs to be laid out at least 24 hours before installation of pods.**

**Step 1** Begin your installation at the far end of the pod line where the Tow Eye will be fitted (do not fit Tow Eye until line is flushed).

**Step 2** For the 4 pod pack, measure along the pipe 1m and install the first pod at this point, then measure 16m and mount the second and from this pod 16m to mount the third and 16m to mount the last pod.

For the 2 pod pack, measure along the pipe 3.5m and install the first pod at this point, then measure 18m and install the second pod.

4 Pod Line:

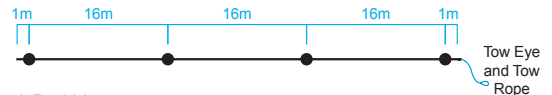

2 Pod Line:



### Step 3



Lay pipe over Skid Base and secure in position with Cross Tee Anchor.



Drill 15mm (9/16") hole at required spacing for the sprinkler type being used and remove all drilling swarf. Ensure the hole is drilled perpendicular to the Pod Base. Caution: Do not drill through both edges of the pipe.



Fit O-ring seal to the under side of Riser. Screw the 20mm Hansen Socket onto the Riser thread and locate riser spigot into hole in pipe. Tighten nuts evenly to fasten the cross tee anchor and tighten socket.



Screw sprinkler into Hansen Socket on riser.



Locate body on skid base and push firmly down to engage grip lugs.



Secure top body by screws around the base.



Fix wire clip into opposing holes on body sides. Ensure the wire runs parallel with the pipe as shown in the image.



Screw wire clip holders into the holes provided.



Flush the irrigation line prior to fitting the pipeline end cap to remove any drilling debris left in the pipe.

**Step 4** Having completed the assembly of the first Pod Skid, measure along the pipe the sprinkler design spacing from the last Pod Skid (see Step 2 for pod spacing). This is where you will place the next Pod Skid. You now need to assemble the Pod (repeat Step 3). When you have completed the assembly of the Pod simply follow Step 4, and Step 3 until you have completed all Pod Skids required on the particular pod line.

**Step 5** You should now have all the Pod Skids fitted to the Sprinkler line. It is best practice to camlock join the Pod line to the Feedline.

We recommend following pipe manufacturers guidelines.

#### Packs Include:

| Irripod Code | Description                 | 2 Pod Pk Qty | 4 Pod Pk Qty | Irripod Code | Description                 | 2 Pod Pk Qty | 4 Pod Pk Qty | Irripod Code      | Description                           | 2 Pod Pk Qty | 4 Pod Pk Qty |
|--------------|-----------------------------|--------------|--------------|--------------|-----------------------------|--------------|--------------|-------------------|---------------------------------------|--------------|--------------|
| IP-BASE-BLK  | Irripod Black Base          | 2            | 4            | CTA32-40LD   | Cross Tee Anchor 32-40 LDPE | 2            | 4            | NA5035SD4.0       | Naan 5035 SD Sprinkler - 4.0mm Nozzle | 2            | 4            |
| IP-COVER-BL  | Irripod Black Top Cover     | 2            | 4            | IP-SEAL      | Riser Seal                  | 2            | 4            | NA SD 3.5         | Naan 3.5mm Nozzle                     | -            | 4            |
| IP-WIRE      | Irripod Wire Protector      | 2            | 4            | HS20         | Hansen 20mm Socket          | 2            | 4            | 15MM DRILL BIT    | 15mm Drill Bit or 9/16"               | 1            | 1            |
| IP-WIRECLIP  | Irripod Wire Retainer Clips | 4            | 8            | HFS32        | Hansen 32mm Female Straight | 1            | 1            | SCREW BIT         | Phillips/Pozi Drill Bit Long          | 1            | 1            |
| IP-UBOLTS    | Irripod U Bolt Bag          | 2            | 4            | HTE32        | 32mm Tow Eye                | 1            | 1            | 13MM RING SPANNER | 13mm Ring Spanner                     | 1            | 1            |
| IP-SCREWS    | Irripod Screw Bag           | 2            | 4            | TOWROPE      | Pod Line Tow Rope           | 1            | 1            | CEELON RED        | Thread Seal Tape                      | 1            | 1            |
| TST32LDL20M  | 32mm LD Low Riser 20 BSP    | 2            | 4            | IP3250       | 32mm x 50m LDPE Pipe        | 1            | 1            |                   |                                       |              |              |

### Irripod Single Pod

**Irripod Single Pod Sprinkler is your complete portable Irrigation solution. Features Include:**

- Irripod Single Pod Sprinkler is designed to operate off a standard 19mm garden hose or 20mm to 25mm Polyethylene Pipe.
- One Irripod Single Pod Sprinkler has a coverage area up to 500sqm and an intensity rate of 2.6mm per hour.
- The Single Pod Sprinkler is designed to operate at very low pressures (3 Bar).

Irripod Single Pod Sprinkler is a versatile, strong, portable Sprinkler Irrigation System. The Single Pod sprinkler is ideally suited to fit in small paddocks or irregular shaped areas where it is difficult to fit traditional irrigation systems. Irripod Single Pod sprinklers are manufactured from commercial grade materials to ensure long life durability and value.

### Installing Single Pod Sprinklers

Prior to commissioning the irrigation line it is recommended that the Single Pod be disconnected and the line flushed to remove any debris.



Thread tape the end of the handle.



Screw on the Hansen Female Straight Coupler or the fitting to match your chosen hose/pipe to the end of the handle.



Attach the handle to the Pod Skid with the 2 u-bolts and screws.



Insert the Hansen Hex Nipple into the Pod Skid Base. Then screw on the Hansen 20mm Female Socket.



Screw the 20mm spinkler into the socket.



Connect hose/pipe to attached fitting.



Locate the Pod cover onto Pod Skid base and push firmly down to engage grip lugs.



Secure top cover by screws around the base.



Fix wire clip into opposing holes on body sides. Ensure the wire runs parallel with the pipe as shown in the image. Screw wire clip holders into the holes provided.

We recommend following pipe manufacturers guidelines.

### Pack Includes:

| Irripod Code | Description                 | Qty | Irripod Code | Description                    | Qty |
|--------------|-----------------------------|-----|--------------|--------------------------------|-----|
| IP-BASE-BK   | Irripod Black Base          | 1   | HANDLE25     | Handle 20mm Female x 25mm Male | 1   |
| IP-COVER-BL  | Irripod Black Top Cover     | 1   | HFS25        | Hansen 25mm Female Straight    | 1   |
| IP-WIRE      | Irripod Wire Protector      | 1   | HS20         | Hansen 20mm Socket             | 1   |
| IP-WIRECLIP  | Irripod Wire Retainer Clips | 2   | SHN20        | Hansen 20mm Hex Nipple         | 1   |
| IP-UBOLTS    | Irripod U Bolt Bag          | 1   | N5035        | Nann 5035 Sprinkler            | 1   |
| IP-SCREWS    | Irripod Screw Bag           | 1   |              |                                |     |

### Exploded View of Pod Assembly 32mm or 40mm Pipe, 15mm Sprinkler

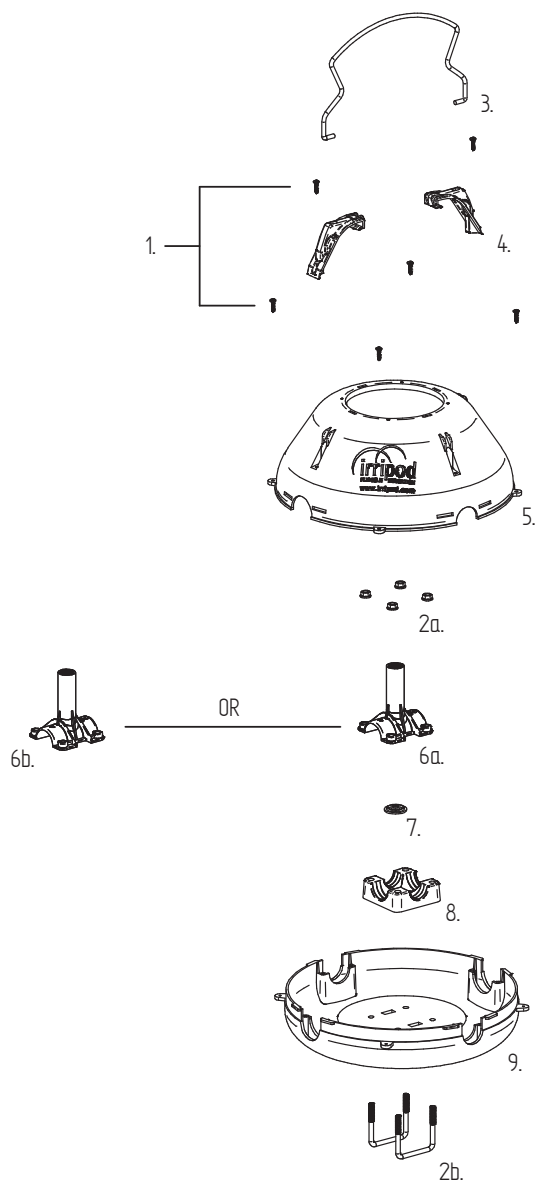

| No.                | Product Code | Item Name                                   | Qty |
|--------------------|--------------|---|-----|
| Screw Bag Contains |              |   |     |
| 1                  | IP-SCREWS    | Medium Self Tapper (10 x 3/4) or (10 x 5/8) | 6   |
| Bolt Bag Contains  |              |   |     |
| 2a                 | IP-UBOLTS    | M8 Flanged Nuts                             | 4   |
| 2b                 | IP-UBOLTS    | M8 U-Bolts                                  | 2   |
| 3                  | IP-WIRE      | Irripod Wire Protector                      | 1   |
| 4                  | IP-WIRECLIP  | Irripod Wire Retainer Clips                 | 2   |
| 5                  | IP-COVER-WH  | Irripod White Top Cover                     | 1   |
| 6a                 | TST32LDH15F  | 32mm LD High Riser                          | 1   |
| 6b                 | TST40LDH15F  | 40mm LD High Riser                          | 1   |
| 7                  | IP-SEAL      | Seal  | 1   |
| 8                  | CTA40-45LD   | Irripod Cross Tee Anchor 32-40 LDPE         | 1   |
| 9                  | IP-BASE-BLK  | Irripod Black Base                          | 1   |

Items 1, 2a-2b, 3, 4, 7 and 8 are included in TSK32-40LDU.

### Exploded View of Pod Assembly 45mm, fits 15mm Sprinkler Pod

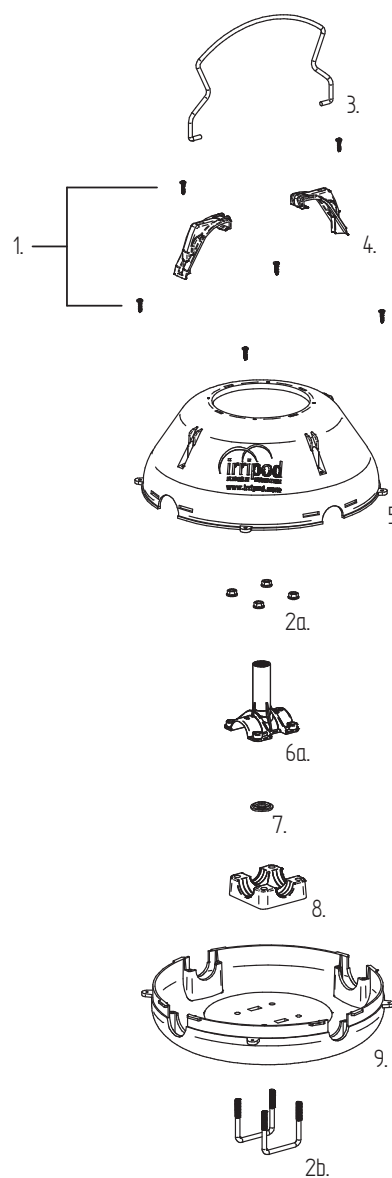

| No.                | Product Code | Item Name                                   | Qty |
|--------------------|--------------|---|-----|
| Screw Bag Contains |              |   |     |
| 1                  | IP-SCREWS    | Medium Self Tapper (10 x 3/4) or (10 x 5/8) | 6   |
| Bolt Bag Contains  |              |   |     |
| 2a                 | IP-UBOLTS    | M8 Flanged Nuts                             | 4   |
| 2b                 | IP-UBOLTS    | M8 U-Bolts                                  | 2   |
| 3                  | IP-WIRE      | Irripod Wire Protector                      | 1   |
| 4                  | IP-WIRECLIP  | Irripod Wire Retainer Clips                 | 2   |
| 5                  | IP-COVER-WH  | Irripod White Top Cover                     | 1   |
| 6                  | TST45LDH15F  | 45mm LD High Riser                          | 1   |
| 7                  | IP-SEAL      | Seal  | 1   |
| 8                  | CTA40-45LD   | Irripod Cross Tee Anchor 40-45 LDPE         | 1   |
| 9                  | IP-BASE-BLK  | Irripod Black Base                          | 1   |

Items 1, 2a-2b, 3, 4, 7 and 8 are included in TSK40-45LDU.

### Exploded View of Pod Assembly 45mm Pipe, 20mm Sprinkler

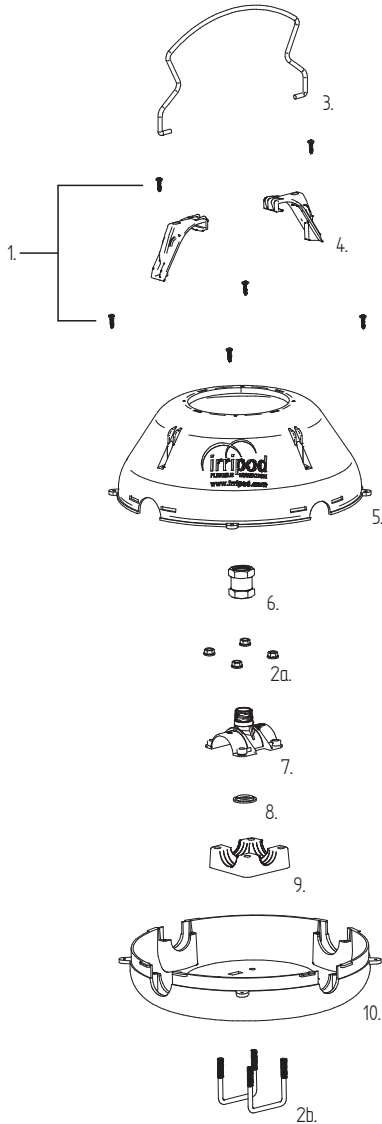

| No. | Product Code       | Item Name                                   | Qty |
|-----|--------------------|---|-----|
|     | Screw Bag Contains |   |     |
| 1   | IP-SCREWS          | Medium Self Tapper (10 x 3/4) or (10 x 5/8) | 6   |
|     | Bolt Bag Contains  |   |     |
| 2a  | IP-UBOLTS          | M8 Flanged Nuts                             | 4   |
| 2b  | IP-UBOLTS          | M8 U-Bolts                                  | 2   |
| 3   | IP-WIRE            | Irripod Wire Protector                      | 1   |
| 4   | IP-WIRECLIP        | Irripod Wire Retainer Clips                 | 2   |
| 5   | IP-COVER-WH        | Irripod White Top Cover                     | 1   |
| 6   | SS20               | 20mm Hansen Socket                          | 1   |
| 7   | TST45LDL20M        | 45mm LD Low Riser                           | 1   |
| 8   | IP-SEAL            | Seal  | 1   |
| 9   | CTA40-45LD         | Irripod Cross Tee Anchor 40-45 LDPE         | 1   |
| 10  | IP-BASE-BLK        | Irripod Black Base                          | 1   |

Items 1, 2a-2b, 3, 4, 8 and 9 are included in TSK40-45LDU.

### Exploded View of Irripod Multi Fit Pod

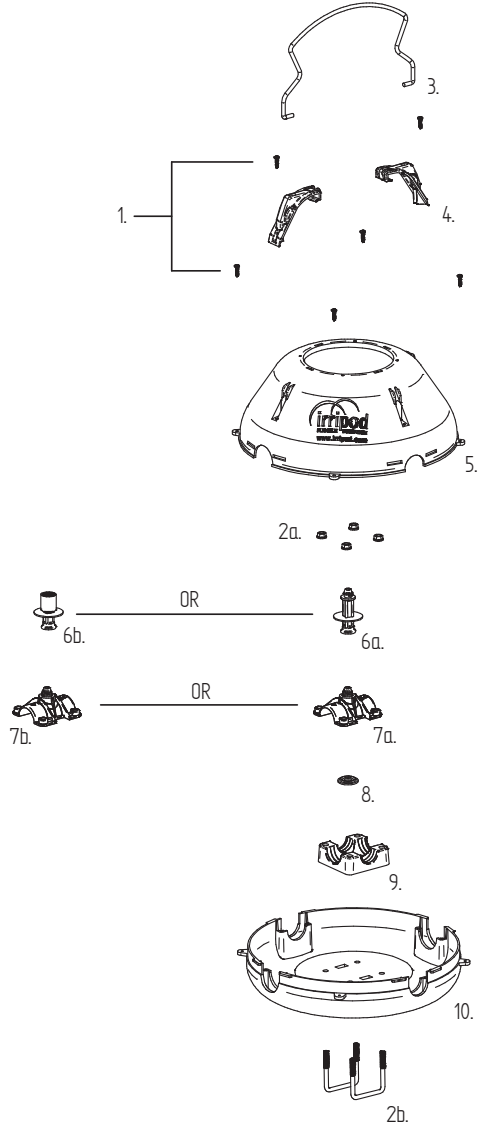

| No. | Product Code       | Item Name                                   | Qty |
|-----|--------------------|---|-----|
|     | Screw Bag Contains |   |     |
| 1   | IP-SCREWS          | Medium Self Tapper (10 x 3/4) or (10 x 5/8) | 6   |
|     | Bolt Bag Contains  |   |     |
| 2a  | IP-BOLTS           | M8 Flanged Nuts                             | 4   |
| 2b  | IP-BOLTS           | M8 U-Bolts                                  | 2   |
| 3   | IP-WIRE            | Irripod Wire Protector                      | 1   |
| 4   | IP-WIRECLIP        | Irripod Wire Retainer Clips                 | 2   |
| 5   | IP-COVER-BL        | Irripod Black Top Cover                     | 1   |
| 6a  | ACME-MF-HA         | ACME Male-Female High Adaptor               | 1   |
| 6b  | ACME-F-MA          | ACME-BSP Female Medium Adaptor              | 1   |
| 7a  | TST32LDLAC         | 32mm LD Low Riser ACME                      | 1   |
| 7b  | TST40LDLAC         | 40mm LD Low Riser ACME                      | 1   |
| 8   | IP-SEAL            | Seal  | 1   |
| 10  | CTA32-40LD         | Irripod Cross Tee Anchor 32-40 LDPE         | 1   |
| 11  | IP-BASE-BLK        | Irripod Black Base                          | 1   |

Items 1, 2a-2b, 3, 4, 8 and 9 are included in TSK32-40LDU.

## Exploded View of Irripod Lifestyle 32 Two & Four Pod Kits

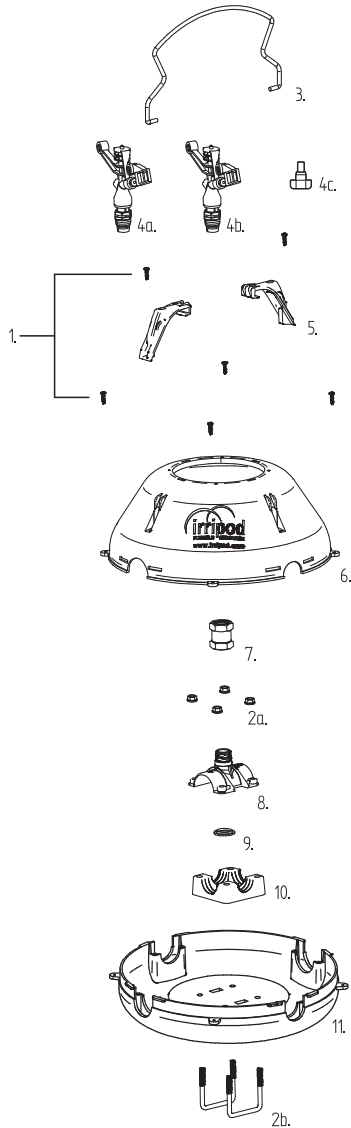

| No.                | Product Code | Item Name                                   | 2 Pod Pk Qty | 4 Pod Pk Qty |
|--------------------|--------------|---|--------------|--------------|
| Screw Bag Contains |              |   |              |              |
| 1                  | IP-SCREWS    | Medium Self Tapper (10 x 3/4) or (10 x 5/8) | 12           | 24           |
| Bolt Bag Contains  |              |   |              |              |
| 2a                 | IP-UBOLTS    | M8 Flanged Nuts                             | 16           | 32           |
| 2b                 | IP-UBOLTS    | M8 U-Bolts                                  | 8            | 16           |
| 3                  | IP-WIRE      | Irripod Wire Protector                      | 2            | 4            |
| 4a                 | NA5035SD4.0  | Naan 5035 SD Sprinkle with 4.0mm nozzle     | 2            | -            |
| 4b                 | NA5035SD3.5  | Naan 5035 SD Sprinkle with 3.5mm nozzle     | -            | 4            |
| 4c                 | NA SD 4.0    | Naan 4.0mm nozzle                           | -            | 4            |
| 5                  | IP-WIRECLIP  | Irripod Wire Retainer Clips                 | 4            | 8            |
| 6                  | IP-COVER-BL  | Irripod Black Top Cover                     | 2            | 4            |
| 7                  | SS20         | 20mm Hansen Socket                          | 2            | 4            |
| 8                  | TST32LDL20M  | 32mm LD Low Riser                           | 2            | 4            |
| 9                  | IP-SEAL      | Seal  | 2            | 4            |
| 10                 | CTA32-40LD   | Irripod Cross Tee Anchor 32-40 LDPE         | 2            | 4            |
| 11                 | IP-BASE-BLK  | Irripod Black Base                          | 2            | 4            |

## Exploded View of Irripod Single Pod

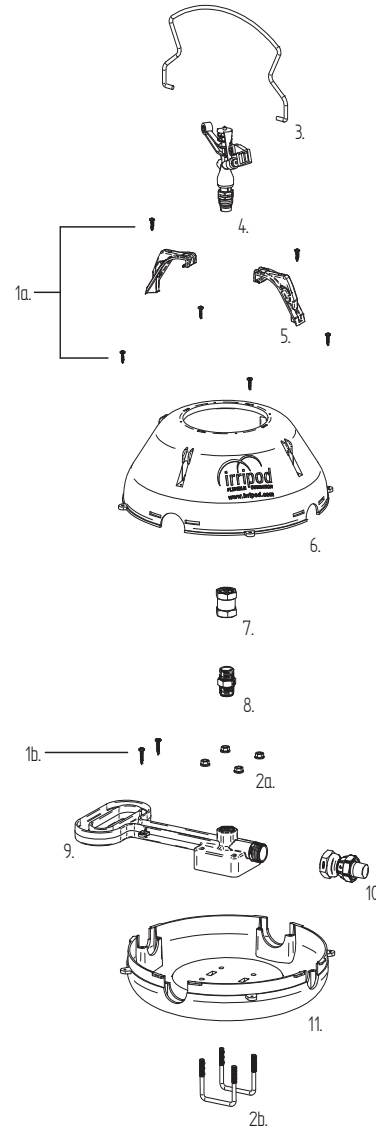

| No.                | Product Code | Item Name                                   | Qty |
|--------------------|--------------|---|-----|
| Screw Bag Contains |              |   |     |
| 1a                 | IP-SCREWS    | Medium Self Tapper (10 x 3/4) or (10 x 5/8) | 6   |
| 1b                 | IP-SCREWS    | Large Self Tapper (12 x 1)                  | 2   |
| Bolt Bag Contains  |              |   |     |
| 2a                 | IP-UBOLTS    | M8 Flanged Nuts                             | 4   |
| 2b                 | M8U-BOLTS    | M8 U-Bolts                                  | 2   |
| 3                  | IP-WIRE      | Irripod Wire Protector                      | 1   |
| 4                  | A329         | Naan 5035 SD Sprinkler (Packed Separately)  | 1   |
| 5                  | IP-WIRECLIP  | Irripod Wire Retainer Clips                 | 2   |
| 6                  | IP-COVER-BL  | Irripod Black Top Cover                     | 1   |
| 7                  | SS20         | 20mm Hansen Socket                          | 1   |
| 8                  | SHIN20       | 20mm Hansen Nipple                          | 1   |
| 9                  | HANDLE25     | Handle 20mm Female x 25mm Male              | 1   |
| 10                 | HFS25        | 25mm Hansen Female Straight Coupling        | 1   |
| 11                 | IP-BASE-BLK  | Irripod Black Base                          | 1   |

Items 1a-1b, 2a-2b, 3, 4, 6 and 8 are included in SINGLEKITU.



# Effluent Distribution System

For all Technical Irripod Irrigation  
queries please either phone or email  
our Irripod Market Manager

Nigel Henigan  
Mobile: + 64 21 963 432  
Email: [nigel.henigan@irripod.com](mailto:nigel.henigan@irripod.com)

## What is an Irripod Effluent System

- Irripod Effluent Systems are flexible cost effective Pod Pipeline Systems for Effluent Distribution.
- Designed to operate at low pressure. The Irripod Effluent System distributes liquid effluent on a slow absorption rate over a 12-24 hour period. This allows for effective absorption into the soil whilst eliminating pooling and run off.
- The Irripod Effluent System is a component system that is simple to install and manage.
- The Irripod Effluent System utilises Protective Pod Skid covers over sprinklers that are attached to a 45mm Effluent Pipeline.
- The Irripod Effluent System can be configured to suit individual requirements depending on the application rates, the distance to be irrigated and the rotation intervals appropriate for the situation.
- Each Irripod Effluent System can be customized to suit varying paddock sizes and shapes while also accommodating existing obstructions.
- Irripod Effluent Systems are strong, lightweight and flexible.
- Easily moved by attaching the Hydrant or Pod lines to an ATV or farm vehicle.
- The Irripod Effluent System is designed to Distribute Liquid Effluent. (solid materials separated via a Dual Pond System or Solid Separator - Not Included).

NOTE: The Irripod Effluent System has been designed to distribute liquid effluent only, it is important to remove solid materials.



## Advantages of an Irripod Effluent System

- Low cost of ownership and maintenance.
- Low application rate, translates into slow absorption into soil whilst eliminating pooling and run off.
- Low labour, the system only requires one person to shift the lines, and does not require specialist training or tools.
- Low pressure system, (2-4Bar) translates into lower running cost.
- Low sprinkler height means less wind drift and effective Effluent distribution.
- Smaller droplet size means less soil compaction.
- Suitable for flat and rolling ground.
- Each Effluent Pod Line can be controlled independently off the system and can be tailored to suit paddock layouts.
- High Flow 20mm Impact Sprinklers, eliminates Nozzle blockages.
- High Volume 45mm Lilac Tri striped Irripod Effluent Mainlines.
- System Specific Hansen<sup>™</sup> 45mm Lilac Polythene Pipe Fittings.
- Quick Release Portable Hydrant Kit.
- The Lilac Pods are highly visible minimising the chance of running over with farm machinery.
- Wire Protector across the Pod provides protection to the Sprinkler, thus eliminating damage.
- Irripod Effluent Systems distribute liquid effluent on a slow absorption rate.
- Irripod Effluent Systems incorporates 45mm (1 3/4") design technology.
- Internationally recognised Lilac colouring depicting effluent dispersal.

***Irripod 45mm  
Effluent Pods  
in use.***

The Irripod Systems in this catalogue are protected by intellectual property rights owned by the Hansen group of companies in New Zealand. For more information refer to the legal information section.

### System Layout

The Irripod Effluent System has been designed to be moved easily by one person, you will require an ATV or farm vehicle to drag the Sub Main Line and Pod Sprinkler Lines (See overleaf for steps).

Your Irripod Effluent System has been provided with the Hansen™ 45mm Male Camlock Fittings for both ends of the 50 metre Sub Main Set and the 120 metre Pod Sprinkler Lines. This allows you to attach the Sub Main Set to the Adaptor Set via a 63mm Drag Hose, or the Pod Sprinkler Lines to the Pod Hydrants from either end.

### System Specifications

#### Sub Main

Sub Main consists of 50 metres of High Volume 45mm Lilac Tri Striped Irripod Effluent Pipe, this pipe is rated at PN5 (71 psi). The Pod Hydrants are attached to the Sub Main Pipe at 20 metre spacings.

#### Pod Sprinkler Lines

Pod Sprinkler Lines consist of 120 metres of High Volume 45mm Lilac Tri Striped Irripod Effluent Pipe, this pipe is rated at PN5 (71 psi). The pipe is marked at 1 metre intervals. The Irripod Effluent Pods are attached to the Pod Lines at 20 metre spacings. Each Pod Line is spaced at 20 metres by 20 metres and has a coverage of 2400 sqm (0.24h).

#### Sprinklers

Naan 5035 SD, Plastic Male Full Circle Impact Sprinkler.

#### Nozzles

Application rates vary with nozzle selection. Note: Irripod Effluent Kit contains Naan 5035SD with 4mm Nozzles.

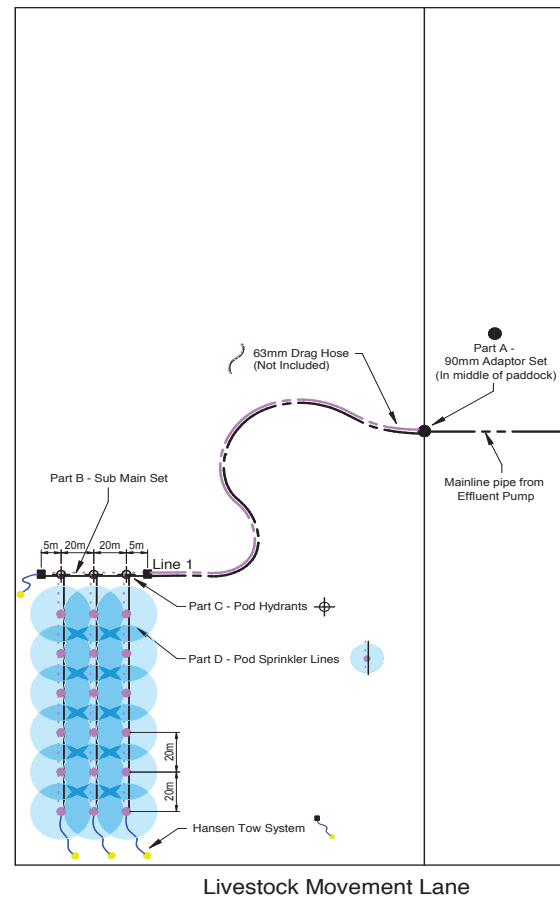

| Nozzle Size<br>mm | Nozzle<br>Colour Code | Flow Rate*<br>l/min | Area<br>(20x 20m)<br>m <sup>2</sup> | Intensity<br>mm/hr | Intensity<br>mm/24hr | Diameter<br>m |
|-------------------|-----------------------|---------------------|-------------------------------------|--------------------|----------------------|---------------|
| 3.5mm             | Blue                  | 12                  | 400                                 | 1.80               | 43.20                | 26.50         |
| 4.0mm             | Black                 | 15.8                | 400                                 | 2.37               | 56.88                | 27.00         |
| 4.5mm             | Brown                 | 20.1                | 400                                 | 3.02               | 72.48                | 28.00         |
| 5.0mm             | Purple                | 24.3                | 400                                 | 3.65               | 87.60                | 30.00         |

#### Operating Pressure

Minimum operating pressure required at each Pod is 2.5 Bar.

## Moving Effluent Pod Sprinkler Lines

### Step 1

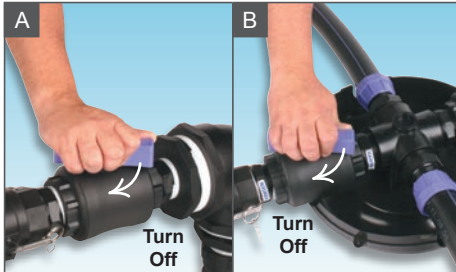

- A.** Turn the Isolating Valve off, this is located on the 90mm Adaptor Set (Part A).
- B.** Turn all the Pod Sprinkler Valves off at the Pod Hydrants (Part B).

### Step 3

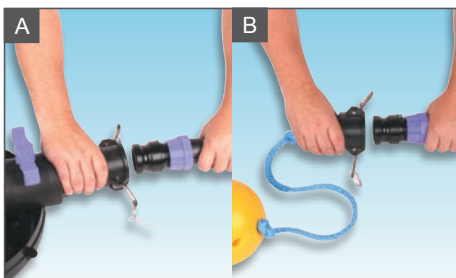

- A.** Disconnect the Male Camlock at the Pod Hydrant end (Part C).
- B.** Connect the Hansen<sup>™</sup> Tow System to the Male Camlock.

### Step 5



Connect the Pod Sprinkler Line to the Pod Hydrant and turn the Pod Sprinkler Line to the on position.

Repeat steps 2 to 5 until all the Pod Sprinkler Lines have been relocated.

Turn the Isolating Valve on and begin irrigating.

When the desired level of effluent has been applied to the paddock turn the Isolating Valve off; this is located on the 90mm Adaptor Set (Part A).

### Step 2



Remove the Hansen<sup>™</sup> Tow System from the Male Camlock at the opposite end of the Pod Sprinkler Line (Part D).

### Step 4

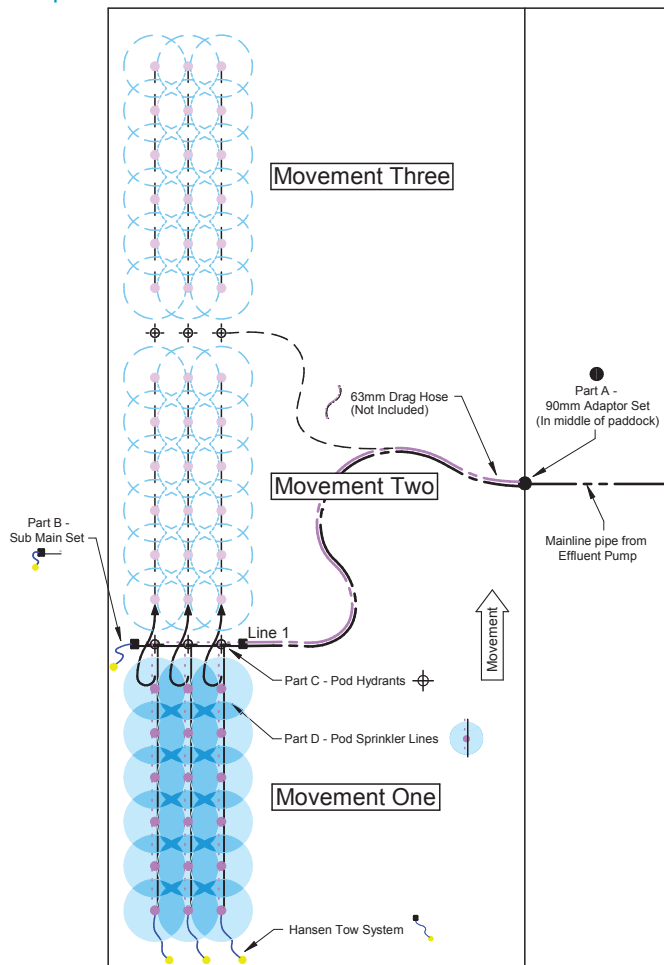

Livestock Movement Lane

Attach the Pod Sprinkler line to an ATV and Proceed to drag the line across the sub main pipe in the opposite direction of the previous location of the line.

**NOTE:** Your Irripod Effluent system has been designed to be turned off when moving the Pod Sprinkler Lines.

### Relocating your Effluent System



**Step 1.** Turn the 90mm Adaptor Set Isolating Valve to off.



**Step 2.** Proceed to turn all the Pod Sprinkler Lines Valves off at the Pod Hydrants.



**Step 3a** Disconnect the Sub Main from the Drag Hose.

**Step 3b** Disconnect each of the Pod Sprinkler Lines from the Pod Hydrants.



**Step 4.** Connect the Sub Main to the ATV via the Hansen™ Tow System; proceed to drag the Sub Main to the new location.



**Step 5.** Connect the Pod Sprinkler Lines to the ATV via the Hansen™ Tow System; proceed to drag the Pod Sprinkler Lines to the new location.



**Step 6.** Disconnect the Drag Hose from 90mm Adaptor Set and drag to new paddock.



**Step 7a.** Re-connect Sub Main to the Drag Hose.

**Step 7b.** Re-connect Pod Sprinkler Lines to Pod Hydrants and turn on the three valves that are connected to the pod sprinkler lines.



**Step 8.** Re-connect the Drag Hose to the Adaptor Set and turn on the Isolating Valve to begin irrigating at the new location.

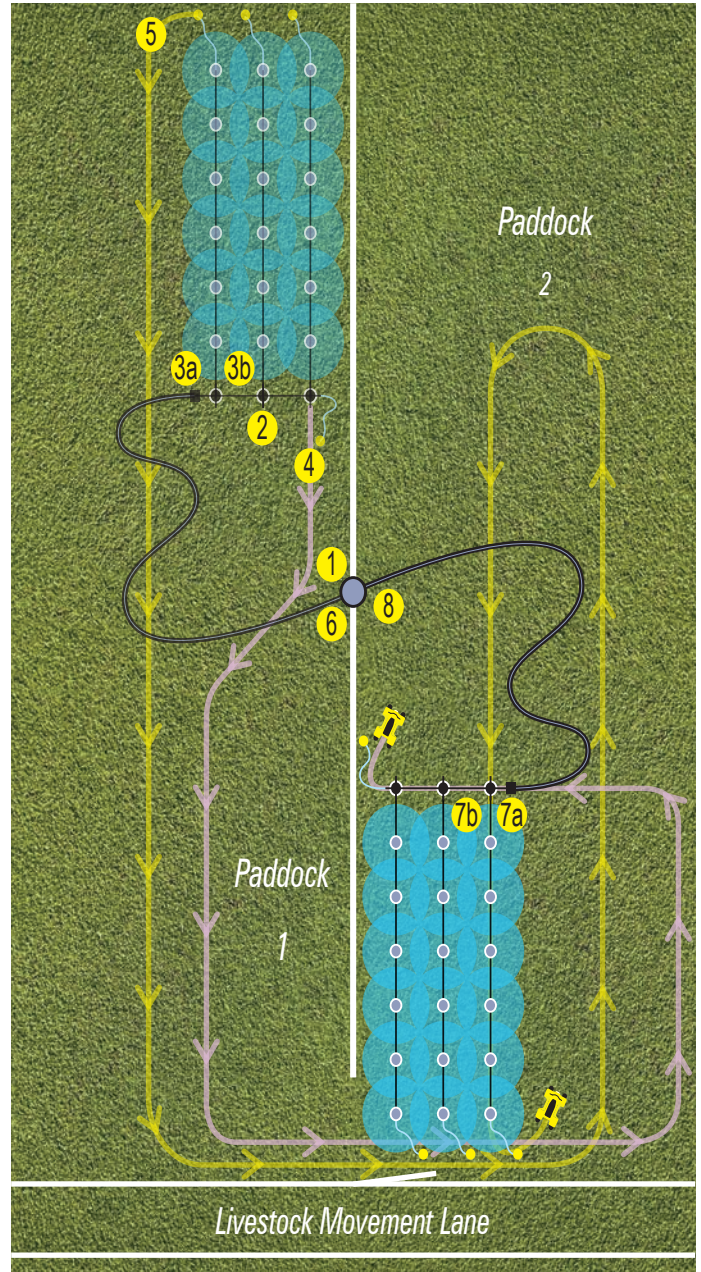

90mm Adaptor Set

ATV or Farm Vehicle

Sub Main Set (with Pod Hydrants)

Towing Movement Lines

Pod Sprinkler Lines

Drag Hose

## EFFLUENT TECHNICAL INFORMATION



### Typical Dairy Effluent Layout

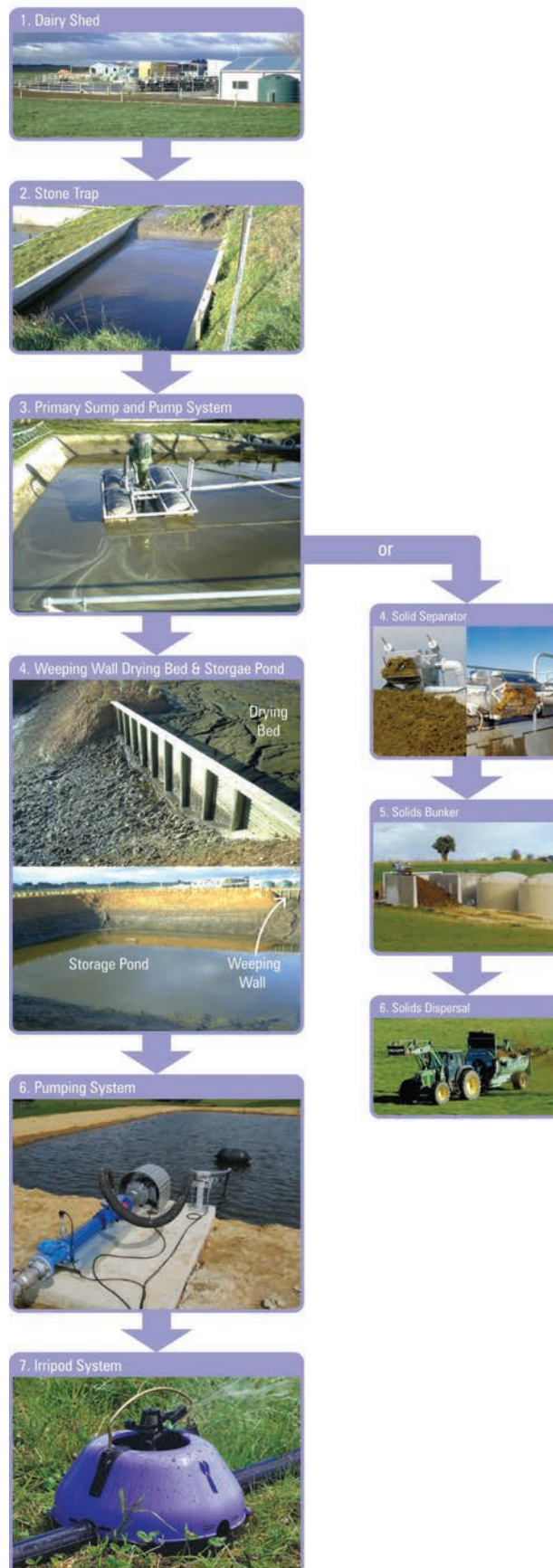

# Exploded View of Irripod Effluent System

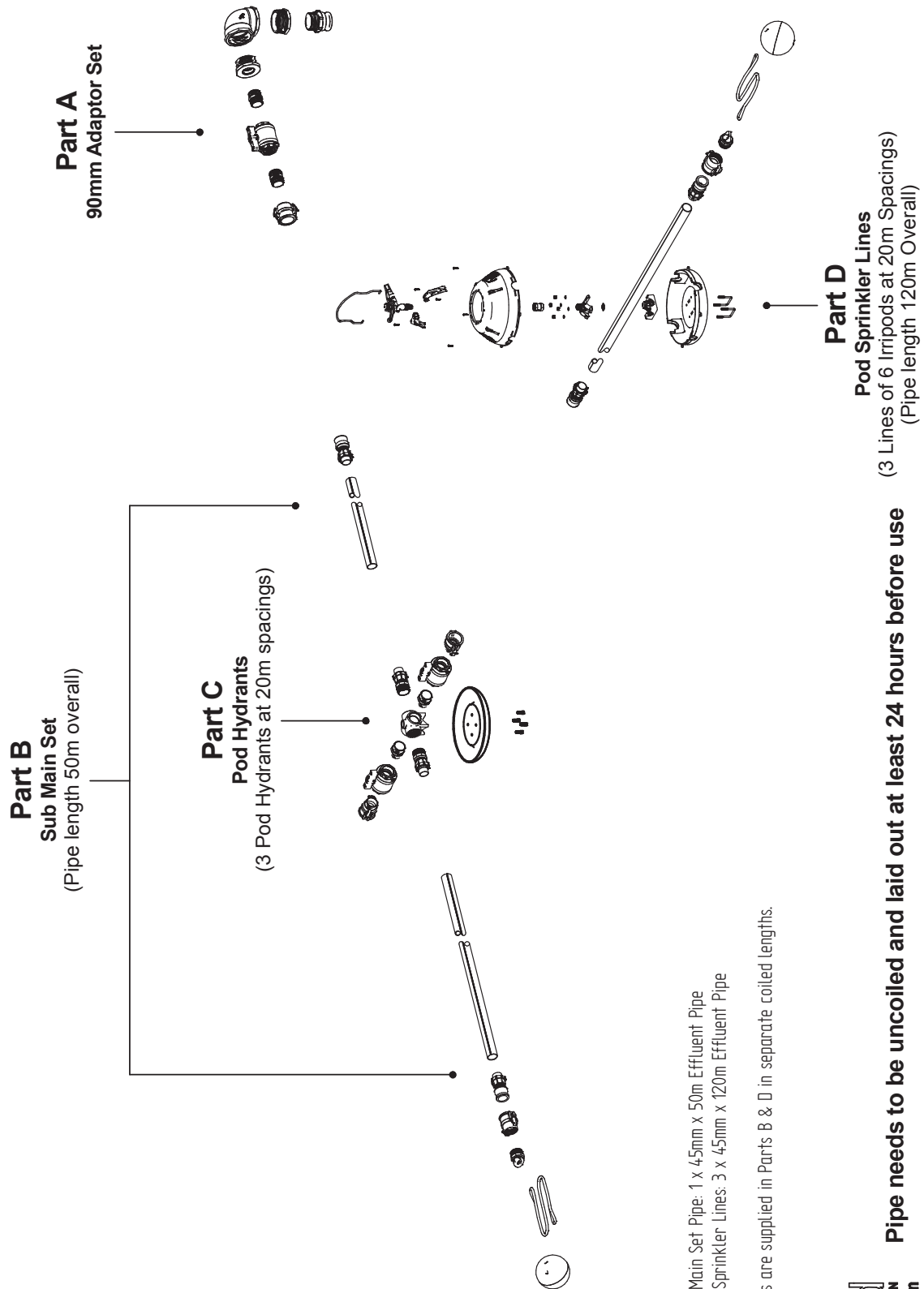

Pipe Details:  
Part B – Sub Main Pipe: 1 x 45mm x 50m Effluent Pipe  
Part D – Pod Sprinkler Lines: 3 x 45mm x 120m Effluent Pipe

Note: All pipes are supplied in Parts B & D in separate coiled lengths.

**Pipe needs to be uncoiled and laid out at least 24 hours before use**

# Typical Irripod Effluent System Layout

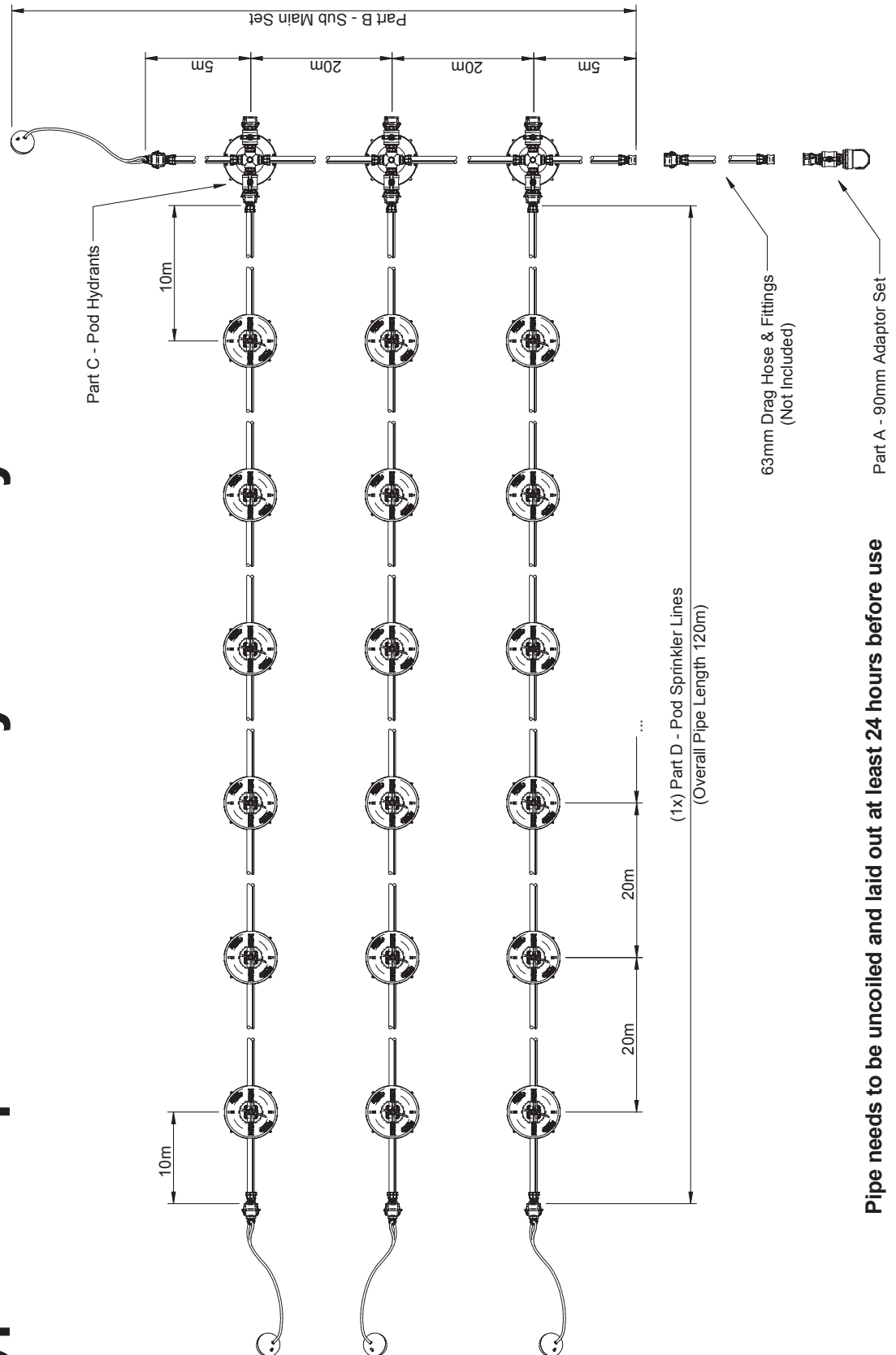

# Effluent Part A - 90mm Adaptor Set

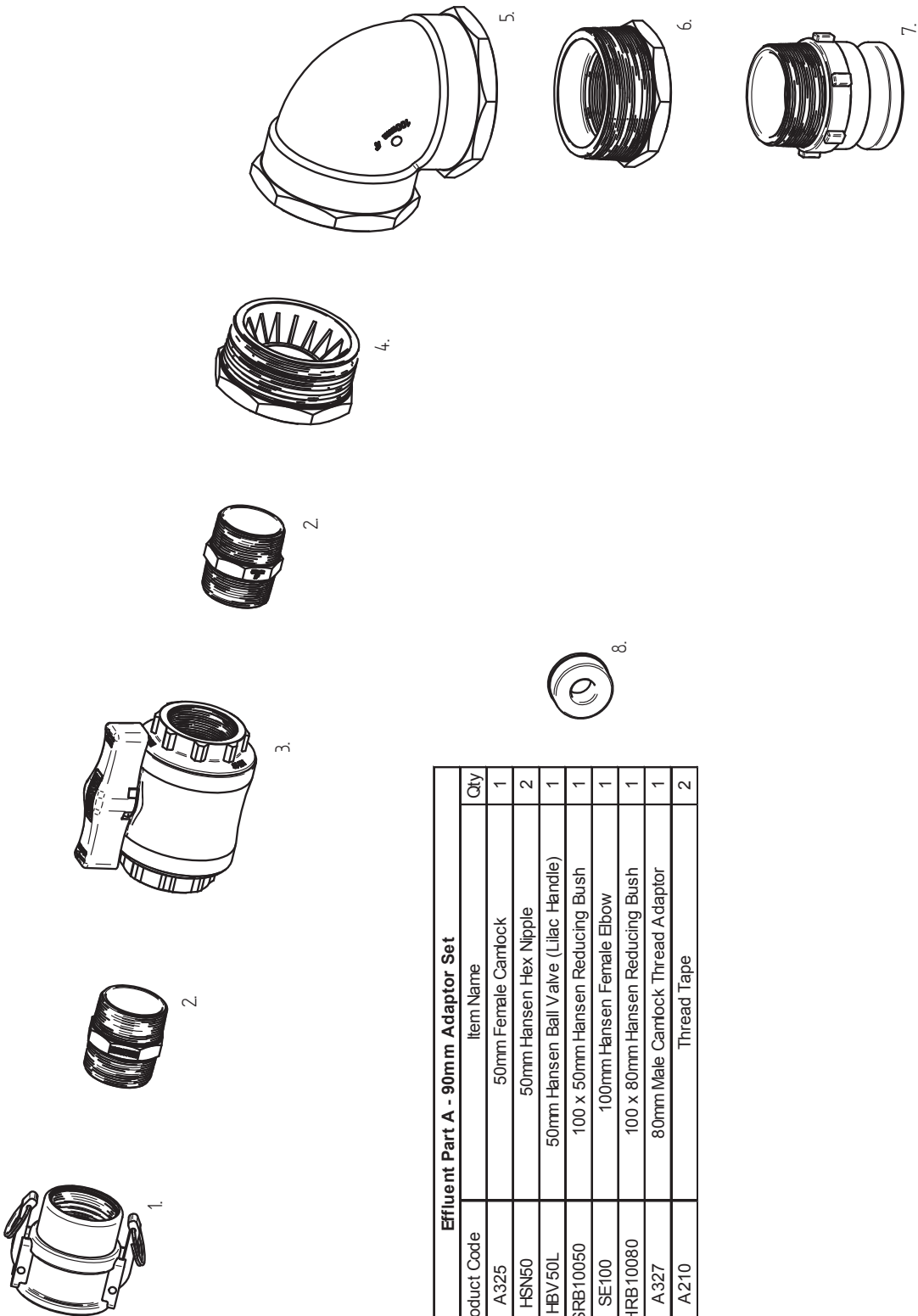

| Effluent Part A - 90mm Adaptor Set |              |                                       |     |
|------------------------------------|--------------|---------------------------------------|-----|
| No.                                | Product Code | Item Name                             | Qty |
| 1                                  | A325         | 50mm Female Camlock                   | 1   |
| 2                                  | HSN50        | 50mm Hansen Hex Nipple                | 2   |
| 3                                  | HBV50L       | 50mm Hansen Ball Valve (Lilac Handle) | 1   |
| 4                                  | SRB10050     | 100 x 50mm Hansen Reducing Bush       | 1   |
| 5                                  | SE100        | 100mm Hansen Female Elbow             | 1   |
| 6                                  | HRB10080     | 100 x 80mm Hansen Reducing Bush       | 1   |
| 7                                  | A327         | 80mm Male Camlock Thread Adaptor      | 1   |
| 8                                  | A210         | Thread Tape                           | 2   |

EFFLUENT TECHNICAL INFORMATION



IRRIPOD

Effluent Part B - Sub Main Set

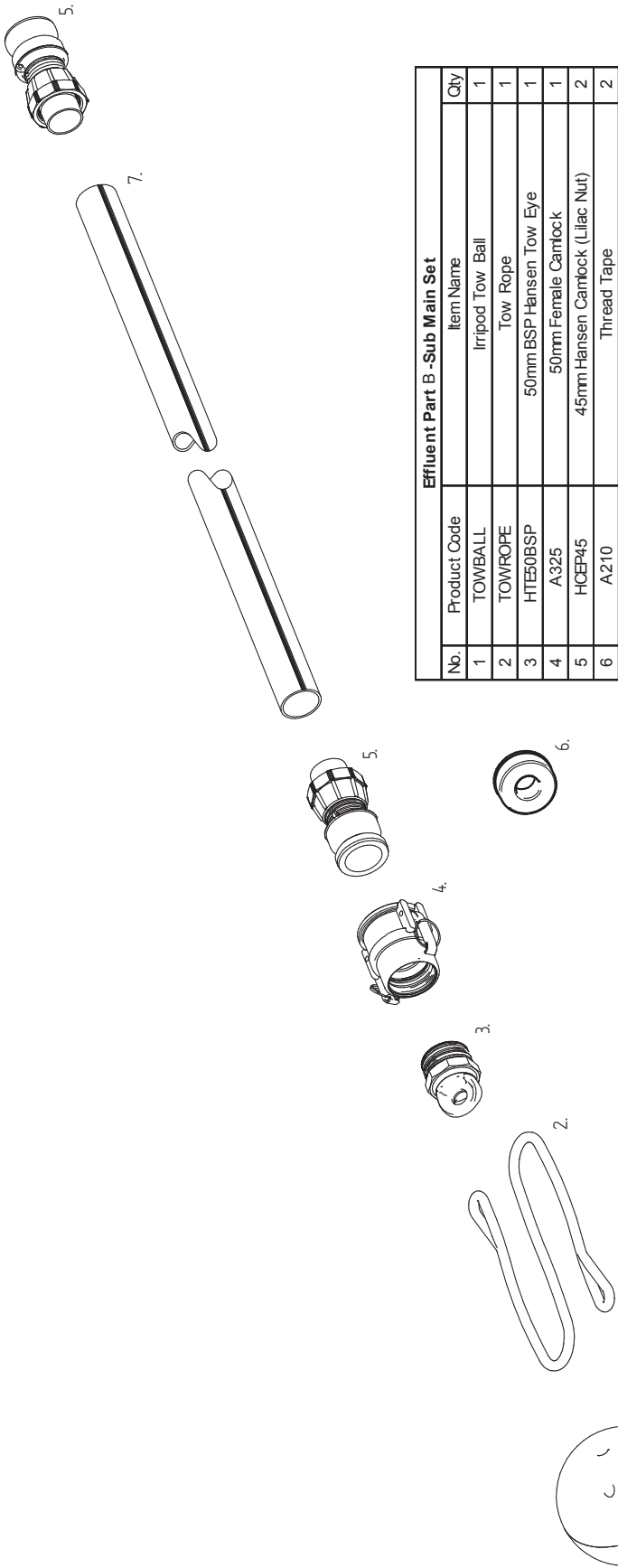

| Effluent Part B - Sub Main Set |              |                                   |
|--------------------------------|--------------|-----------------------------------|
| No.                            | Product Code | Item Name Qty                     |
| 1                              | TOWBALL      | Irripod Tow Ball 1                |
| 2                              | TOWROPE      | Tow Rope 1                        |
| 3                              | HTE50BSP     | 50mm BSP Hansen Tow Eye 1         |
| 4                              | A325         | 50mm Female Camlock 1             |
| 5                              | HCEP45       | 45mm Hansen Camlock (Lilac Nut) 2 |
| 6                              | A210         | Thread Tape 2                     |

| 45mm Effluent Pipe (Pipe Coil Supplied Separately) |                |                            |
|--|----------------|----------------------------|
| No.  | Product Code   | Item Name Qty              |
| 7  | 2230.45PN5.120 | Effluent Pipe 45mm x 50m 1 |



Pipe needs to be uncoiled and laid out at least 24 hours before use

# Effluent Part C - Pod Hydrants

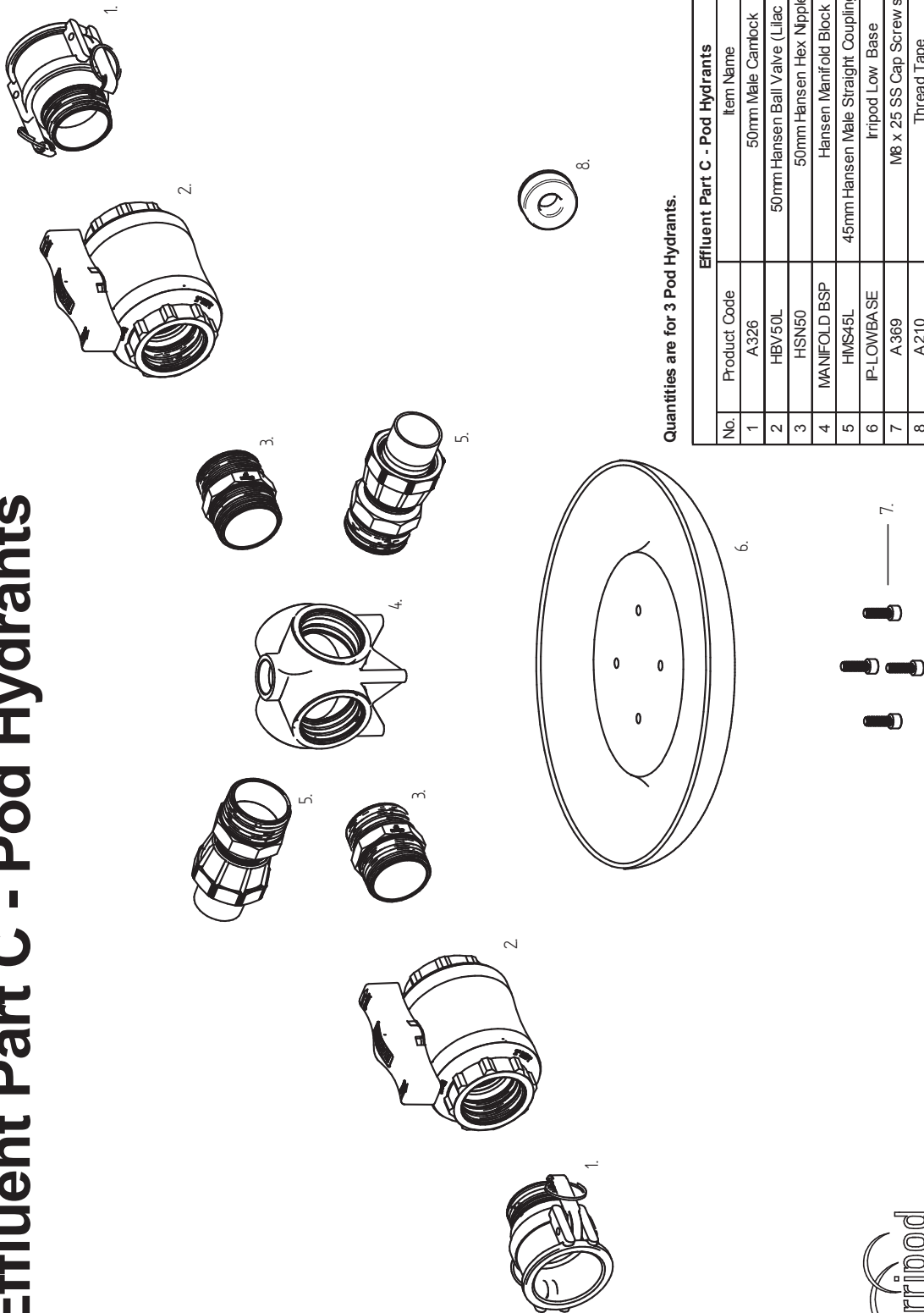

Quantities are for 3 Pod Hydrants.

| Effluent Part C - Pod Hydrants |              |  |
|--------------------------------|--------------|--|
| No.                            | Product Code | Item Name                                      |
| 1                              | A326         | 50mm Male Camlock                              |
| 2                              | HBV50L       | 50mm Hansen Ball Valve (Lilac Handle)          |
| 3                              | HSN50        | 50mm Hansen Hex Nipple                         |
| 4                              | MANIFOLD BSP | Hansen Manifold Block                          |
| 5                              | HMS45L       | 45mm Hansen Male Straight Coupling (Lilac Nut) |
| 6                              | IP-LOWBASE   | Irripod Low Base                               |
| 7                              | A369         | M8 x 25 SS Cap Screws                          |
| 8                              | A210         | Thread Tape                                    |

## EFFLUENT TECHNICAL INFORMATION



IRRIPOD

# Effluent Part D - Pod Sprinkler Lines

Quantities are for 1 Pod Sprinkler Line (1 Carton).  
PLEASE NOTE there are 3 cartons per Effluent System.

| Effluent Part D - Pod Sprinkler Lines |                    |   |     |
|---------------------------------------|--------------------|---|-----|
| No.                                   | Product Code       | Item Name                                   | Qty |
| 1                                     | Screw Bag Contains | Medium Self Tapper (10 x 3/4) or (10 x 5/8) | 36  |
| 2a                                    | Bolt Bag Contains  | M8 Flanged Nuts                             | 24  |
| 2b                                    | IP-UBOLTS          | M8 U-Bolts                                  | 12  |
| 3                                     | IP-WIRE            | Irripod Wire Protector                      | 6   |
| 4                                     | A329               | Naan 5035 SD Sprinkler (Packed Separately)  | 6   |
| 5                                     | IP-WIRECLIP        | Irripod Wire Retainer Clips                 | 12  |
| 6                                     | IP-COVER-LI        | Irripod Lilac Top Cover                     | 6   |
| 7                                     | SS20               | 20mm Hansen Socket                          | 6   |
| 8                                     | TST45LDL20M        | 45mm LD Low Riser                           | 6   |
| 9                                     | IF0701             | IP-Seal                                     | 6   |
| 10                                    | CTA40-45LD         | Irripod Cross Tee Anchor 40-45 LDPE         | 6   |
| 11                                    | IP-BA SE-BLK       | Irripod Black Base                          | 6   |
| 12                                    | HOEP45 (45)        | 45mm Hansen Camlock (with Lilac Nut)        | 2   |
| 13                                    | A325               | 50mm Female Camlock                         | 1   |
| 14                                    | HTE50BSP           | 50mm BSP Hansen Tow Eye                     | 1   |
| 15                                    | TOWROPE            | Tow Rope                                    | 1   |
| 16                                    | TOWBALL            | Irripod Tow Ball                            | 1   |

Items 1, 2a-2b, 3, 5, 8 and 10 are included in TSK40-45LDU.

| 45mm Effluent Pipe (Pipe Coil Supplied Separately) |                |                           |
|--|----------------|---------------------------|
| No.  | Product Code   | Item Name                 |
| 17   | 2230.45PNS.120 | Effluent Pipe 45mm x 120m |

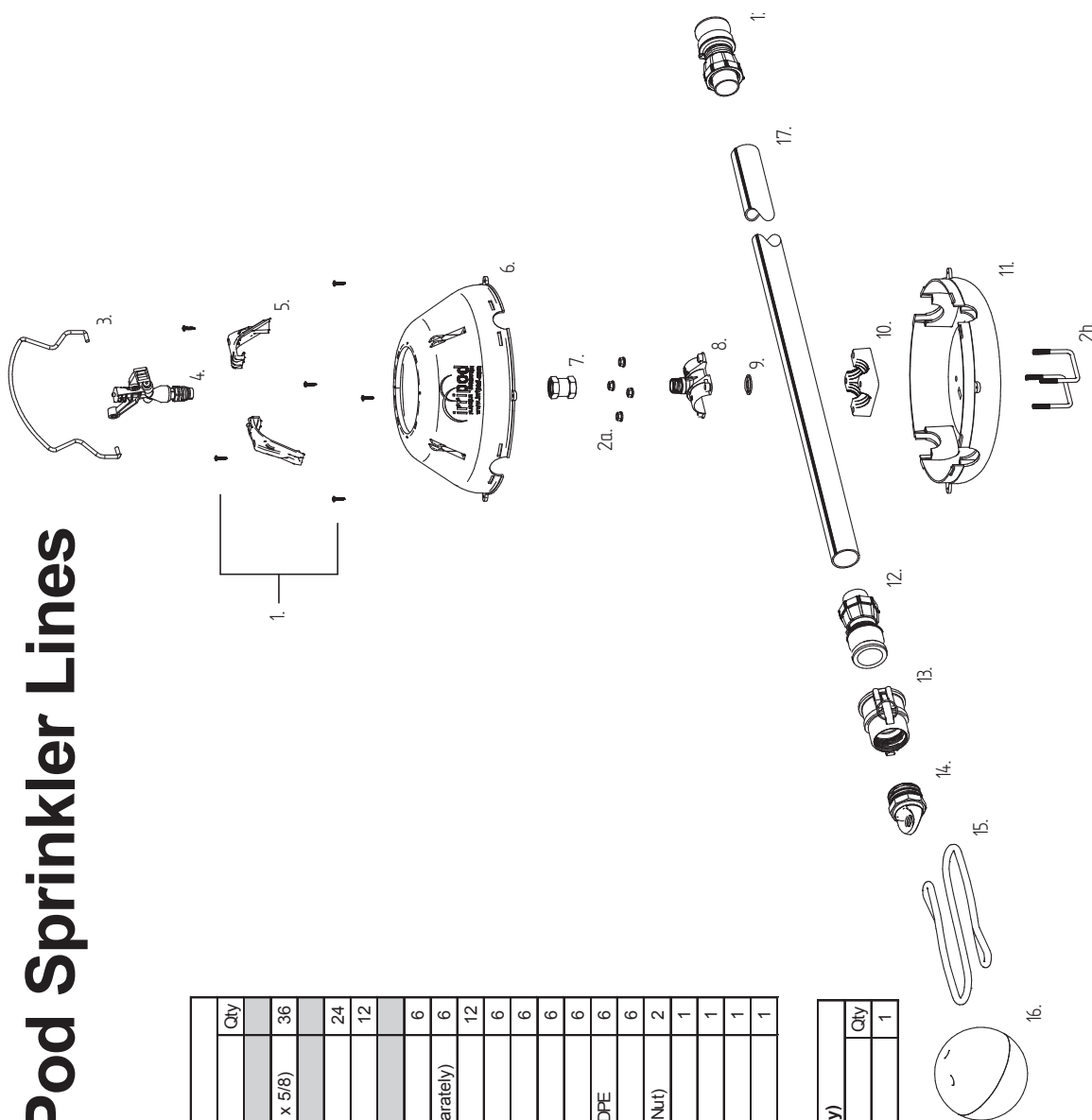

Pipe needs to be uncoiled and laid out at least 24 hours before use



EFFLUENT TECHNICAL INFORMATION

# Irripod 45mm Effluent Pod

| Irripod 45mm Effluent Pod |              |   |     |
|---------------------------|--------------|---|-----|
| No.                       | Product Code | Item Name                                   | Qty |
| Screw Bag Contains        |              |   |     |
| 1                         | IP-SCREWS    | Medium Self Tapper (10 x 3/4) or (10 x 5/8) | 6   |
| Bolt Bag Contains         |              |   |     |
| 2a                        | IP-UBOLTS    | M8 Flanged Nuts                             | 4   |
| 2b                        | IP-UBOLTS    | M8 U-Bolts                                  | 2   |
| IP-WIRE                   |              |   |     |
| 3                         | IP-WIRE      | Irripod Wire Protector                      | 1   |
| 4                         | IP-WIRECLIP  | Irripod Wire Retainer Clips                 | 2   |
| 5                         | IP-COVER-LI  | Irripod LiIac Top Cover                     | 1   |
| 6                         | SS20         | 20mm Hansen Socket                          | 1   |
| 7                         | TST45LDL20M  | 45mm LD Low Riser                           | 1   |
| 8                         | IP-SEAL      | Seal  | 1   |
| 9                         | CTA40-45LD   | Irripod Cross Tee Anchor 40-45 LDPE         | 1   |
| 10                        | IP-BASE-BLK  | Irripod Black Base                          | 1   |

Items 1, 2a-2b, 3, 4, 8 and 9 are included in TSK40-45LDU.

